



**POOLE
TOWNSEND**

Strathmore Avenue, Walney, Barrow-In-Furness, LA14 3DH

£189,500

3 1 1



- Semi- detached property
- Modern fitted kitchen
- Garden to the front and rear
- Suitable for a variety of buyers
- Council tax band B
- Open lounge area
- Three bedrooms
- Off road parking to the front
- Situated in a popular part of Walney



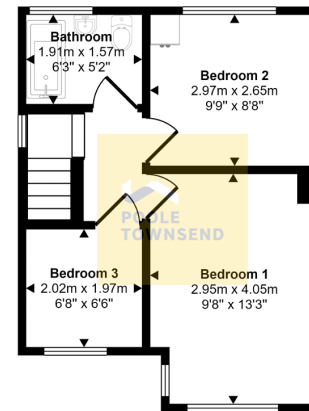

First Floor
Approx 32 sq m / 345 sq ft

This floorplan is only for illustrative purposes and is not to scale. Measurements of rooms, doors, windows, and any items are approximate and no responsibility is taken for any error, omission or mis-statement. Icons of items such as bathroom suites are representations only and may not look like the real items. Made with Made Snappy 360.

NEW Semi-detached property with open lounge area through to a modern fitted kitchen, three bedrooms, bathroom, garden front and rear. Off road parking to the front. Suitable for a variety of buyers including first time buyers. Situated in a popular part of Walney, is conveniently located for access to local schools, bus services and a Tesco Metro store.

Visit us at
www.pooletownsend.co.uk
enquiries@pooletownsend.co.uk

We are open
 Monday – Friday 9.00 – 5.00
 Saturday 9.00 – 1.00

Barrow 01229 811811
 Ulverston 01229 588111
 Grange 015395 33316
 Kendal 01539 734455
 Milnthorpe 015395 62044