



**POOLE
TOWNSEND**

White Combe Way, Askam-in-furness, LA16 7FA

£285,000

🛏️ 4 🍽️ 2 🛋️ 2



- Beautiful Family Home
- Residential Location
- Open Plan Living
- Four Bedrooms
- 4 Piece Family Bathroom
- Master En-Suite
- Landscaped Rear Garden
- Off Road Parking
- Attached Garage
- Close To Local Amenities



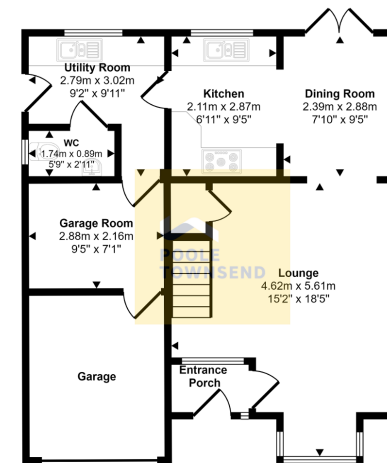

Ground Floor
Approx 63 sq m / 674 sq ft

This floorplan is only for illustrative purposes and is not to scale. Measurements of rooms, doors, windows, and any items are approximate and no responsibility is taken for any error, omission or mis-statement. Icons of items such as bathroom suites are representations only and may not look like the real items. Made with Made Snappy 360.

NEW PRICE Semi-Detached Family Home situated within the village location of Askam-in-Furness. This home has an open plan living kitchen diner, along with utility room and W/C to the ground floor. The first floor provides four bedrooms, one of which is en-suite as well as a modern 4 piece family bathroom. Externally, the property benefits from a landscaped rear garden as well as off road-parking to the front, as well as a garage for storage.

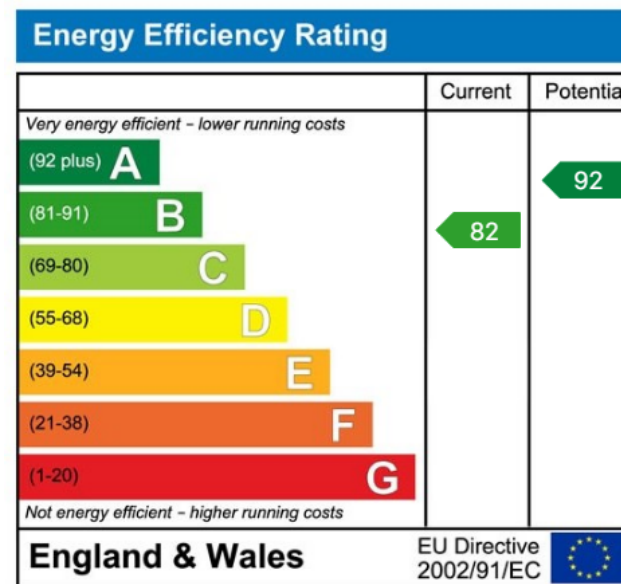

Visit us at
www.pooletownsend.co.uk
enquiries@pooletownsend.co.uk

We are open
 Monday – Friday 9.00 – 5.00
 Saturday 9.00 – 1.00

Barrow 01229 811811
 Ulverston 01229 588111
 Grange 015395 33316
 Kendal 01539 734455
 Milnthorpe 015395 62044