



**POOLE
TOWNSEND**

Bermuda Crescent, Walney, Barrow-in-furness, LA14 3DJ

£220,000

🛏️ 3 🚿 1 🚗 1



- Family Sized property
- Well presented throughout
- Lounge with doors leading into the porch
- Smartly presented bathroom
- Private Driveway parking and garden to the front and rear
- Situated in a lovely location
- Modern fixtured and fittings
- Three bedrooms
- No upper chain
- Council tax band B



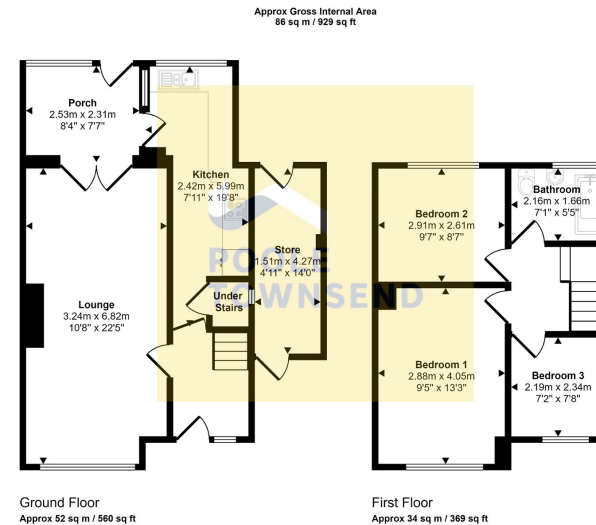

This floorplan is only for illustrative purposes and is not to scale. Measurements of rooms, doors, windows, and any items are approximate and no responsibility is taken for any error, omission or mis-statement. Icons of items such as bathroom suites are representations only and may not look like the real items. Made with Made Snazzy 360.

NEW This family sized property is situated in a lovely location that is convenient for local schools, bus service, shops and the beach. The accommodation is well presented throughout, offering modern fixtures and fittings, double glazing (except 1 small window), gas central heating, private driveway parking and gardens to the front and rear. There is a nice size lounge with double doors leading into the glazed porch, fitted kitchen with integrated appliances, three bedrooms including two double rooms and a smartly presented bathroom. No upper chain.

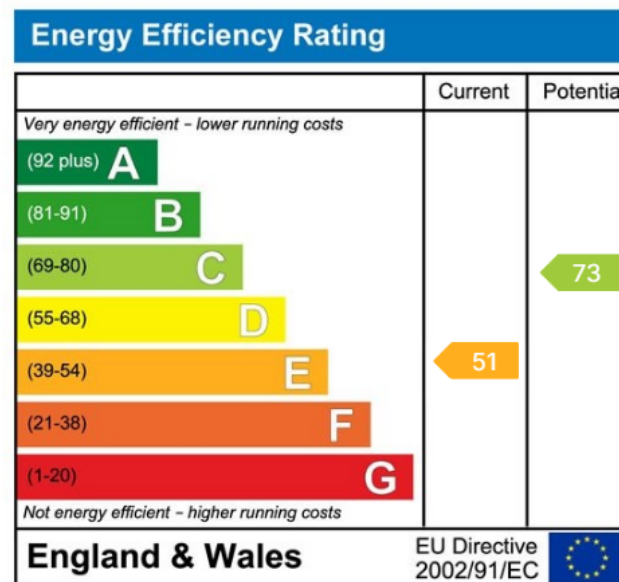

Visit us at
www.pooletownsend.co.uk
enquiries@pooletownsend.co.uk

We are open
 Monday – Friday 9.00 – 5.00
 Saturday 9.00 – 1.00

Barrow 01229 811811
 Ulverston 01229 588111
 Grange 015395 33316
 Kendal 01539 734455
 Milnthorpe 015395 62044