



**POOLE
TOWNSEND**

Holbeck Park Avenue, Barrow-in-furness, LA13 0RE

£350,000

3 2 2



- Immaculately presented home
- Colourful and well tended garden to the front and rear
- Dual aspect lounge with separate dining room
- Gas - fired central heating
- No upper chain
- Situated in a lovely residential location in Holbeck
- Three double bedrooms with fitted wardrobes, storage and fitted drawers
- Property has a UPVC framed double glazing
- Private parking
- Door leading from garage to rear garden



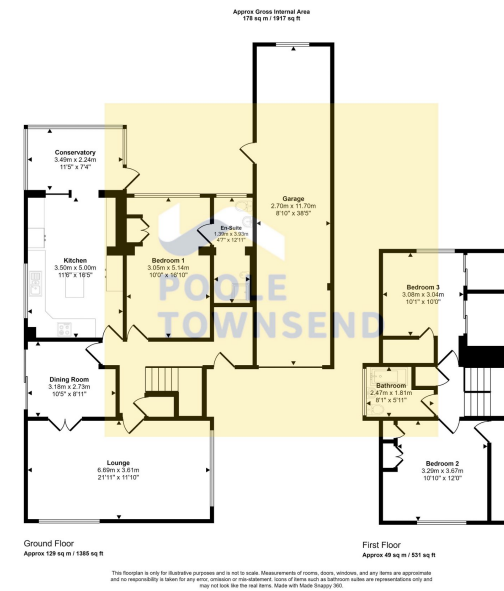

NEW**This is an immaculately presented home which is situated in a lovely residential location in Holbeck. There is a colourful and well tended garden to the front and also to the rear where there is patio and access to an extended garage. The accommodation includes three double bedrooms, the main bedroom is on the ground floor featuring an en-suite shower room. The living space comprises a dual aspect lounge with separate dining room and an extended breakfast kitchen with conservatory alongside. The property has UPVC framed double glazing throughout and gas-fired central heating, private parking and no upper chain.

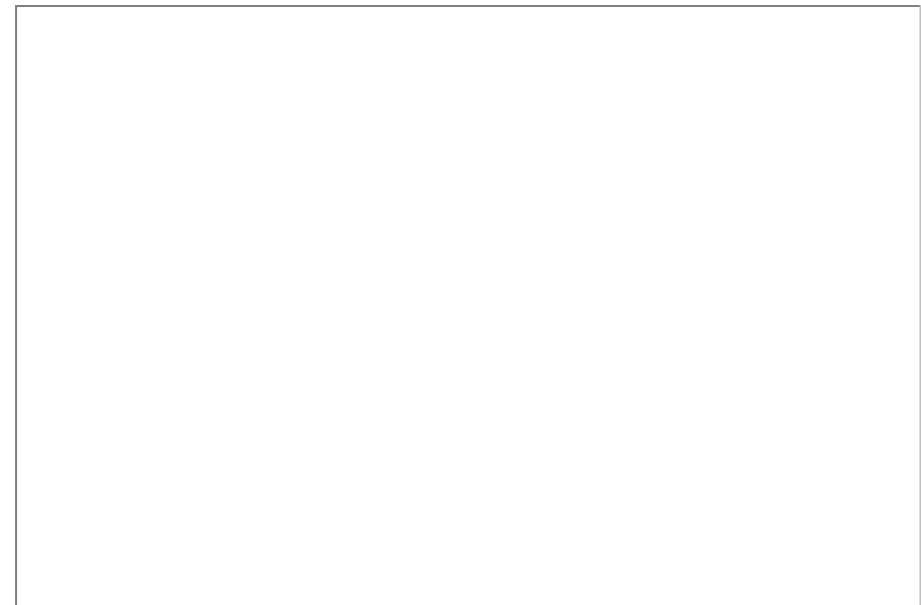

Visit us at
www.pooletownsend.co.uk
enquiries@pooletownsend.co.uk

We are open
 Monday – Friday 9.00 – 5.00
 Saturday 9.00 – 1.00

Barrow 01229 811811
 Ulverston 01229 588111
 Grange 015395 33316
 Kendal 01539 734455
 Milnthorpe 015395 62044