



**POOLE
TOWNSEND**

Croft Park Grove, Barrow-in-Furness

£545,000

4 2 3



DIRECTIONS

Satnav: LA13 9NJ, number 2

What3words: amended.searching.steepest

LOCATION Croft Park Grove is considered to be in one of the town's prime residential locations, within a comfortable walk of the local bus service and schools including Chetwynde, St Bernard's and Barrow Sixth Form College, collectively catering for age groups from three through to 18 years old. Other amenities that are just a short car journey away include a Co-op, children's play area, Furness General Hospital and also the historic Furness Abbey and amphitheatre.

DESCRIPTION **NEW PRICE** This fine detached property offers excellent 'kerb appeal'. There is gated access onto the private driveway, where there is extensive parking as well as access to a double garage. The porch shelters the composite-style entrance door which opens into the main hallway, where there is a stairwell immediately ahead of you and doors leading off into the lounge, kitchen, shower room and utility room. The living areas are extensive and well-proportioned, consisting of three rooms, with the main lounge offering two points of access into the garden as well as a lovely view onto the lawn and patio. This bright and airy room centres around the solid fuel stove which has a stone hearth and a rustic mantle. There are glazed multi-pane doors leading into the adjacent dining room, which is a nicely appointed room with direct access into the kitchen and also to the family room extension. The dining room has a lovely view of the front garden. The kitchen offers a contemporary feel, with the fitted units finished in a light shade of grey with a woodgrain texture. There is a beautiful work surface which extends throughout the kitchen with a matching upstand plus an under-mounted ceramic sink unit with a mixer tap, two integrated ovens, a halogen-style hob with a concealed cooker hood plus a family sized fridge and freezer. There is also concealed accent lighting beneath the wall-mounted cabinet that has a central plate rack and display shelf above. The washing machine, clothes dryer and additional fridge/freezer are located within the utility room which is just the other side of the hallway. There is also further wall and



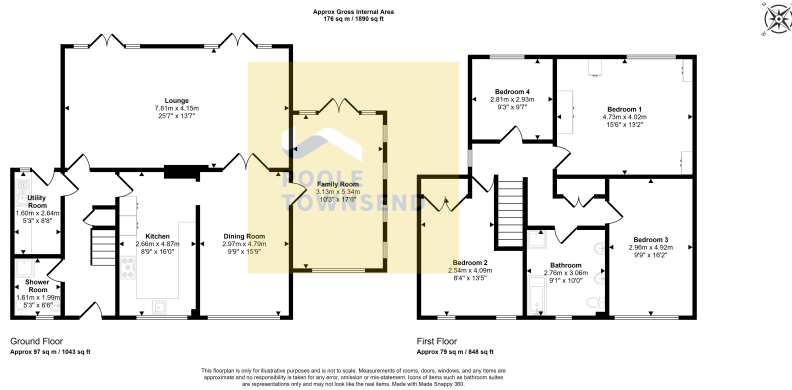

- Luxurious Family Home
- Ample Parking
- Front & Rear Garden
- Open Plan Living Areas
- Sought After Location
- Detached Property
- 4 Double Bedrooms
- Well Presented Property
- Gas Central Heating
- Close to Schools and Amenities

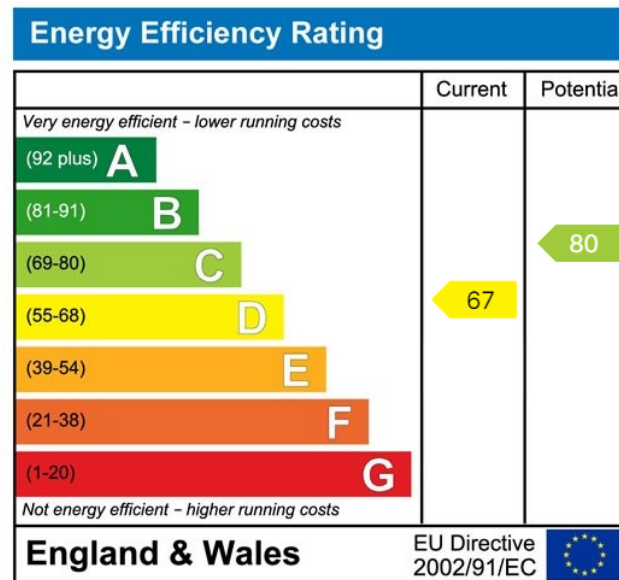

Visit us at
www.pooletownsend.co.uk
enquiries@pooletownsend.co.uk

We are open
 Monday – Friday 9.00 – 5.00
 Saturday 9.00 – 1.00

Barrow 01229 811811
 Ulverston 01229 588111
 Grange 015395 33316
 Kendal 01539 734455
 Milnthorpe 015395 62044