



**POOLE
TOWNSEND**

Winfield Gardens, Allithwaite, Grange over Sands

£450,000

🛏️ 4 🍽️ 2 🚗 1



- Ideal family home
- Open countryside views
- Large kitchen/diner
- Master bedroom with en suite
- Enclosed garden
- Generous living space
- Small modern development
- Freehold
- 4 bedrooms
- Council tax band E



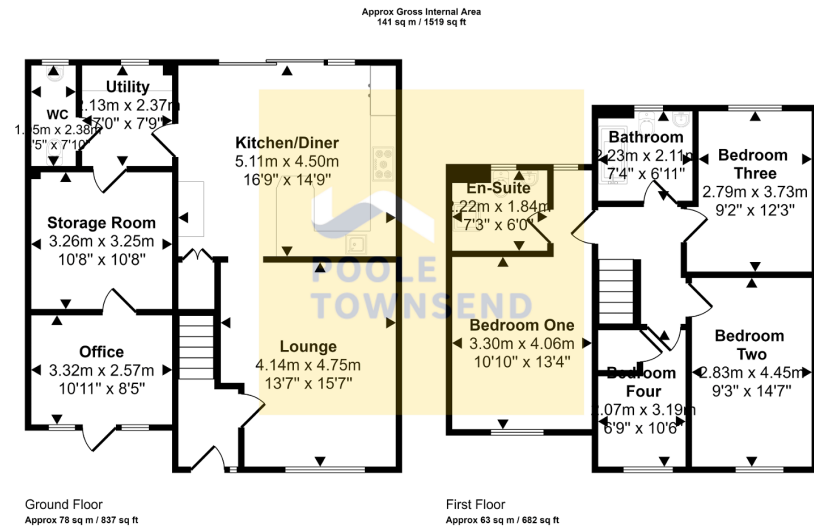

This floorplan is only for illustrative purposes and is not to scale. Measurements of rooms, doors, windows, and any items are approximate and no responsibility is taken for any error, omission or mis-statement. Icons of items such as bathroom suites are representations only and may not look like the real items. Made with Made Snappy 360.

Situated in the exclusive Whinfield Gardens development, is this impressive four bedroom family home. Enjoying picturesque views towards Morecambe Bay, this wonderfully light property features generous sized living accommodation over two floors, along with ample driveway parking and an enclosed rear garden.

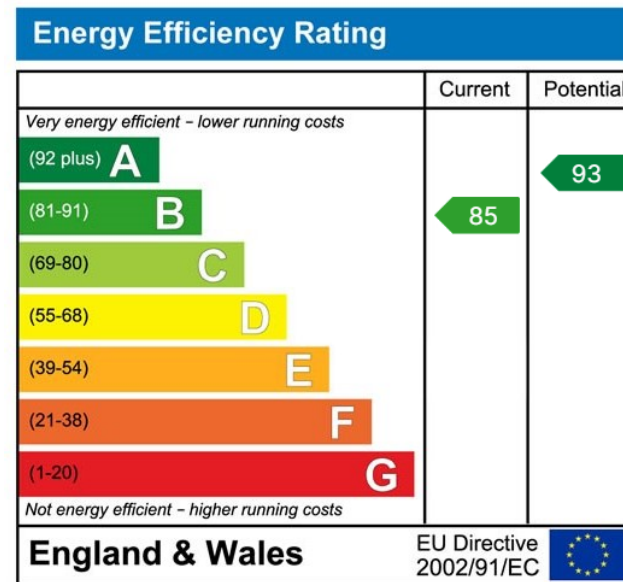

Visit us at
www.pooletownsend.co.uk
enquiries@pooletownsend.co.uk

We are open
 Monday – Friday 9.00 – 5.00
 Saturday 9.00 – 1.00

Barrow 01229 811811
 Ulverston 01229 588111
 Grange 015395 33316
 Kendal 01539 734455
 Milnthorpe 015395 62044