



**POOLE
TOWNSEND**

Grayrigge Court, Kents Bank Road, Grange-over-Sands,
£97,500

1 1 1



- Ground floor apartment
- Council tax B
- Stylish kitchen
- Private patio
- Communal lounge
- Leasehold
- Bright an airy
- Double bedroom
- Laundry facilities
- Modern shower room



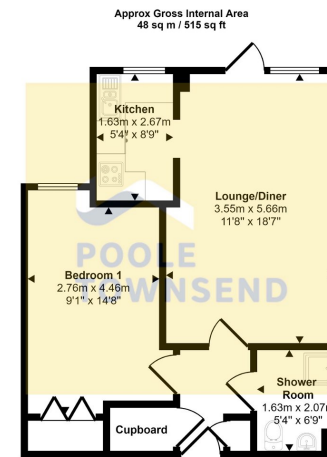

Floorplan

This floorplan is only for illustrative purposes and is not to scale. Measurements of rooms, doors, windows, and any items are approximate and no responsibility is taken for any error, omission or mis-statement. Icons of items such as bathroom suites are representations only and may not look like the real items. Made with Made Snappy 360.

New Price Situated within the popular Grayrigge Court development, is this well-presented, bright and airy ground floor apartment. Offering generously proportioned accommodation which includes a double bedroom with fitted wardrobes, a modern shower room, a lounge/diner with fixed electric fire and a stylish kitchen. Complete with direct access onto a private patio and the shared use of the communal garden, lounge and laundry facilities, this property must be viewed to be appreciated. Please note this property is for over 60's only.

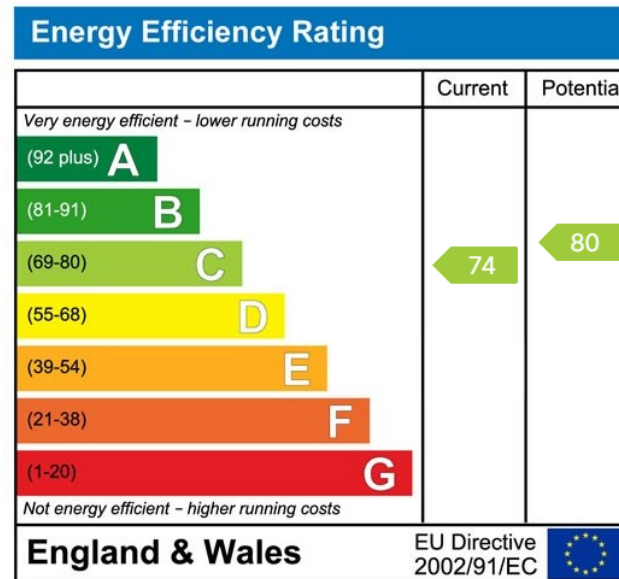

Visit us at
www.pooletownsend.co.uk
enquiries@pooletownsend.co.uk

We are open
 Monday – Friday 9.00 – 5.00
 Saturday 9.00 – 1.00

Barrow 01229 811811
 Ulverston 01229 588111
 Grange 015395 33316
 Kendal 01539 734455
 Milnthorpe 015395 62044