



**POOLE  
TOWNSEND**



# 20 Sandgate Country Park, Flookburgh

£230,000

3 2 1





- Picturesque Rural Location
- Stunning Cedar Clad Lodge
- Bright & Airy
- Views
- Situated on the Edge of The Cartmel Valley
- 3 Double Bedrooms
- Open Plan Living
- Open 52 Weeks





Approx Gross Internal Area  
84 sq m / 902 sq ft

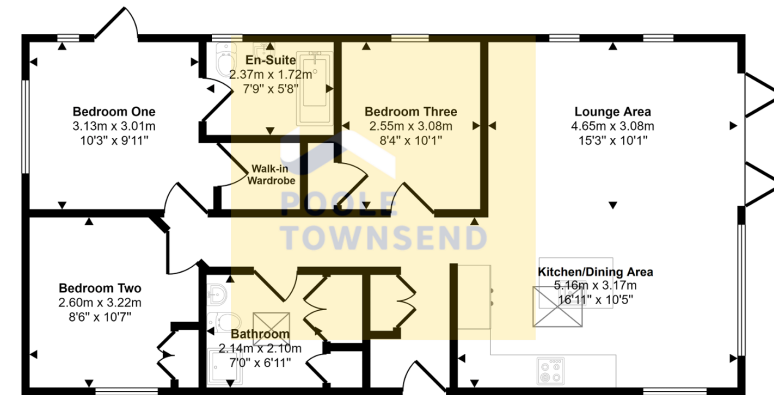

Floorplan

This floorplan is only for illustrative purposes and is not to scale. Measurements of rooms, doors, windows, and any items are approximate and no responsibility is taken for any error, omission or mis-statement. Icons of items such as bathroom suites are representations only and may not look like the real items. Made with Made Snappy 360.

Situated in a picturesque rural location on the edge of Cartmel Valley, is this truly stunning, cedar clad eco lodge. Bright and airy throughout and enjoying views onto the tranquil surroundings, this high quality lodge features a spacious open plan living room, with glazed doors opening onto a decked seating area, 3 double bedrooms and two contemporary bathrooms. Please Note: Not to be used as a permanent residence. No sub-letting. The Season runs a full 12 months

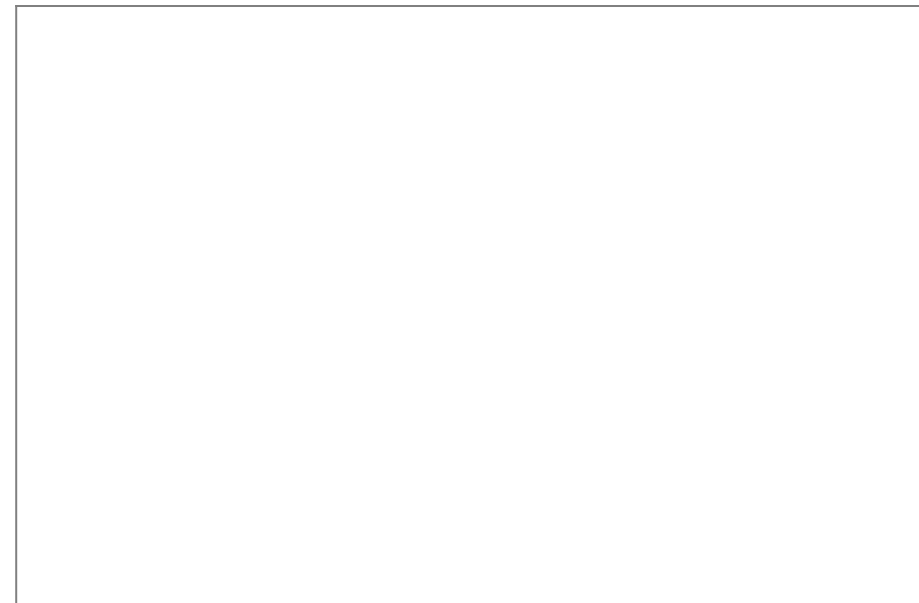

Visit us at  
[www.pooletownsend.co.uk](http://www.pooletownsend.co.uk)  
[enquiries@pooletownsend.co.uk](mailto:enquiries@pooletownsend.co.uk)

We are open  
 Monday – Friday 9.00 – 5.00  
 Saturday 9.00 – 1.00

Barrow 01229 811811  
 Ulverston 01229 588111  
 Grange 015395 33316  
 Kendal 01539 734455  
 Milnthorpe 015395 62044