



**POOLE  
TOWNSEND**

# Grange Mews, Station Square, Grange over Sands, Cumbria LA11 6EH

£145,000

1 1 1



- Ground floor flat
- Small Patio Area
- Close to transport links
- Grade II listed
- No upper chain
- Double bedroom
- Allocated Parking
- Close to shops
- Leasehold
- Council Tax Band: A



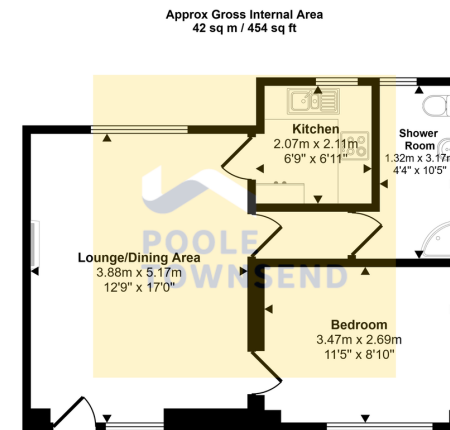

Floorplan

This floorplan is only for illustrative purposes and is not to scale. Measurements of rooms, doors, windows, and any items are approximate and no responsibility is taken for any error, omission or mis-statement. Icons of items such as bathroom suites are representations only and may not look like the real items. Made with Made Snappy 360.

Converted from a former coaching house and stables for the Grange Hotel, 7 Grange Mews is a delightful Grade II listed ground floor apartment. Generously proportioned throughout, the accommodation includes a lounge/diner with views onto the courtyard, a modern kitchen with fitted appliances, a double bedroom and shower room. With the added benefit of a designated parking space, a small patio for a bistro table and within a level walk of many amenities and transport links, this property will appeal to those seeking a main residence or holiday home. No Chain. The Vendor owns a share of freehold.

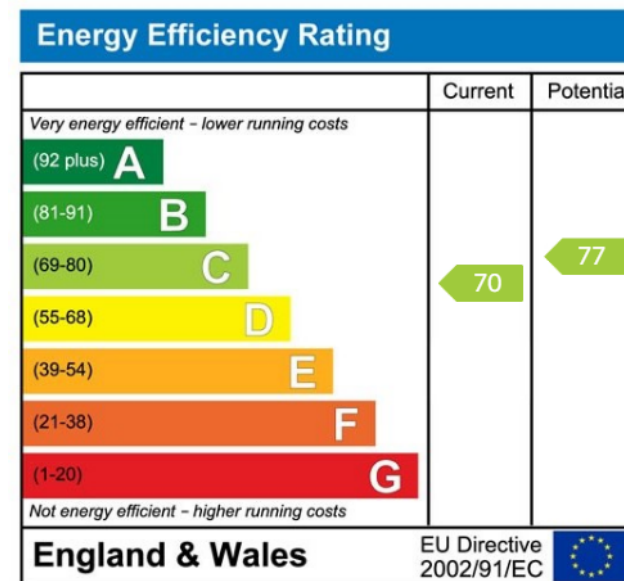

Visit us at  
[www.pooletownsend.co.uk](http://www.pooletownsend.co.uk)  
[enquiries@pooletownsend.co.uk](mailto:enquiries@pooletownsend.co.uk)

We are open  
 Monday – Friday 9.00 – 5.00  
 Saturday 9.00 – 1.00

Barrow 01229 811811  
 Ulverston 01229 588111  
 Grange 015395 33316  
 Kendal 01539 734455  
 Milnthorpe 015395 62044