



**POOLE
TOWNSEND**

Flat, Hampsfell Grange, Grange over Sands

£120,000

1 1 1



- Popular independent living development for the over 60s in the heart of Grange-over-Mendips
- Offers a bright lounge/diner, a well-appointed kitchen
- Excellent communal facilities, including a welcoming residents' lounge
- Convenient laundry room
- Beautifully maintained surrounding gardens
- Offered with no onward chain
- Residents benefit from the reassurance of 24-hour emergency pull cords



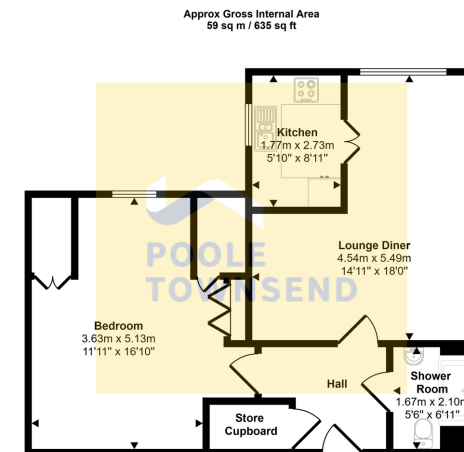

Floorplan

This floorplan is only for illustrative purposes and is not to scale. Measurements of rooms, doors, windows, and any items are approximate and no responsibility is taken for any error, omission or mis-statement. Icons of items such as bathroom suites are representations only and may not look like the real items. Made with Made Snappy 360.

Situated within a popular independent living development for the over 60s in the heart of Grange-over-Sands, this impressive second-floor apartment boasts stunning elevated views over Morecambe Bay. Wonderfully light and airy, the apartment offers generously sized accommodation ideal for comfortable and secure retirement living. The layout includes a spacious double bedroom with built-in furniture, a bright lounge/diner, a well-appointed kitchen, and a modern shower room. Residents benefit from the reassurance of 24-hour emergency pull cords, as well as access to excellent communal facilities, including a welcoming residents' lounge, convenient laundry room, and beautifully maintained surrounding gardens. Offered with no onward chain, this superb apartment represents an ideal opportunity to join a friendly and supportive community in a central location. **Please note: This is an over-60s development.**

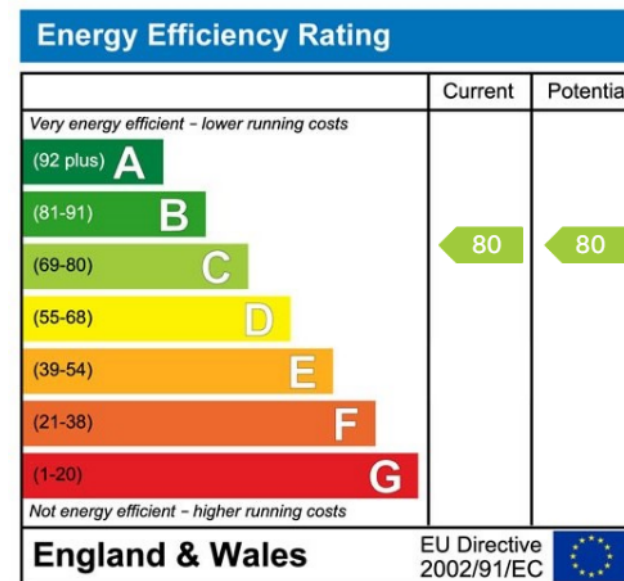

Visit us at
www.pooletownsend.co.uk
enquiries@pooletownsend.co.uk

We are open
 Monday – Friday 9.00 – 5.00
 Saturday 9.00 – 1.00

Barrow 01229 811811
 Ulverston 01229 588111
 Grange 015395 33316
 Kendal 01539 734455
 Milnthorpe 015395 62044