



Cartmel Road, Grange-over-Sands

£595,000

 0  0

An exciting opportunity to purchase an impressive area of land extending to approx 1.94 acres , allocated for residential development. The land sits in a desirable and elevated location off Allithwaite Road, allowing picturesque views over Morecambe Bay towards Far Arnside and Silverdale.

- Land allocated for residential development local
- extending to approx. 1.94 acers
- views over Morecambe Bay
- Desirable elevated location

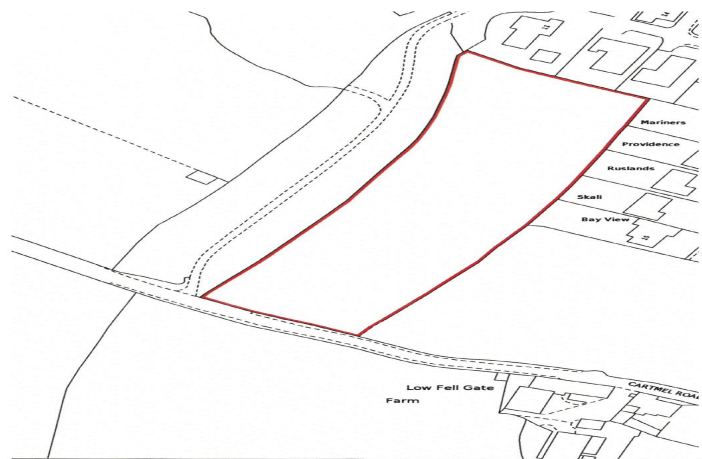

Floor Area: sq. ft.

Tenure: Freehold

Service Charge: £ per annum

Ground Rent: £0 per annum

