



**POOLE
TOWNSEND**

The Orchard, Grange-over-Sands

£148,500

1 1 1



- 1 Bedroomed Ground Floor Apartment
- Popular Village Location
- Allocated Parking
- Couples or Rental Investors
- Council Tax Band B
- Immaculate and Well Presented
- Private Garden
- Ideal First Home
- Leasehold
- No Upper Chain





An immaculate and well presented ground floor flat, centrally located within the popular village of Lindale. The property provides generous size accommodation on one level, complemented with a private garden and allocated parking. An ideal home for first time buyers, couples or rental investors. No chain.

Approx Gross Internal Area
36 sq m / 392 sq ft

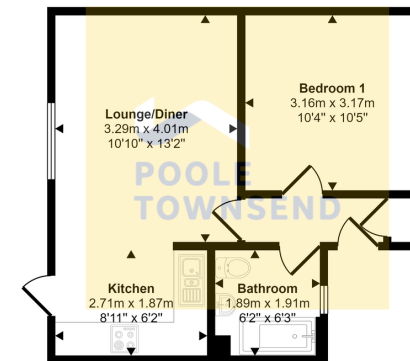

Floorplan

This floorplan is only for illustrative purposes and is not to scale. Measurements of rooms, doors, windows, and any items are approximate and no responsibility is taken for any error, omission or mis-statement. Icons of items such as bathroom suites are representations only and may not look like the real items. Made with Made Snappy 360.

Energy Efficiency Rating

	Current	Potential
Very energy efficient – lower running costs		
(92 plus) A		
(81-91) B		
(69-80) C	72	75
(55-68) D		
(39-54) E		
(21-38) F		
(1-20) G		
Not energy efficient – higher running costs		
England & Wales	EU Directive 2002/91/EC	

Visit us at
www.pooletownsend.co.uk
enquiries@pooletownsend.co.uk

We are open
 Monday – Friday 9.00 – 5.00
 Saturday 9.00 – 1.00

Barrow 01229 811811
 Ulverston 01229 588111
 Grange 015395 33316
 Kendal 01539 734455
 Milnthorpe 015395 62044