



**POOLE  
TOWNSEND**



Flat 1 Kentholme, Kents Bank Road, Grange over Sands  
£270,000

3 1 1





- Two storey maisonette
- Three bedrooms
- Central location
- Beautifully presented
- Freehold
- Spacious accomodation
- Private courtyard
- Contemporary kitchen
- Downstairs Cloak Room
- Council tax band B





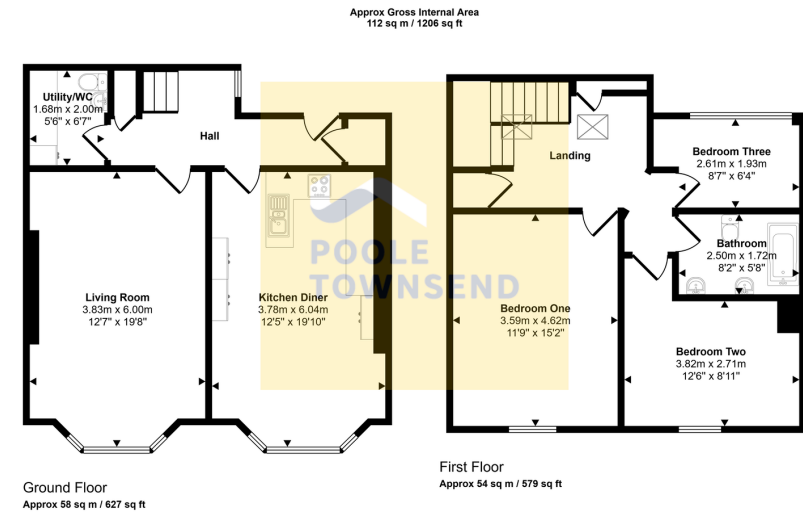

This floorplan is only for illustrative purposes and is not to scale. Measurements of rooms, doors, windows, and any items are approximate and no responsibility is taken for any error, omission or mis-statement. Icons of items such as bathroom suites are representations only and may not look like the real items. Made with Made Snappy 360.

Centrally located within the picturesque Edwardian town of Grange-over-Sands, this impressive and immaculately presented two-storey maisonette offers spacious and naturally bright accommodation. Spread over two floors, the property boasts a large bay-windowed lounge and a bay-windowed kitchen/diner, both with delightful views over Kents Bank Road, as well as a practical utility room and cloakroom on the ground floor. The first floor features a generous landing area leading to three well-proportioned bedrooms, two doubles and a single, along with a stylish and contemporary bathroom. Outside, the property benefits from a charming courtyard garden with a patio seating area, providing a perfect space for relaxation. Conveniently located just a short walk from the town centre's amenities, this superb maisonette is an ideal choice for those seeking a main residence, a second home or even a holiday let.

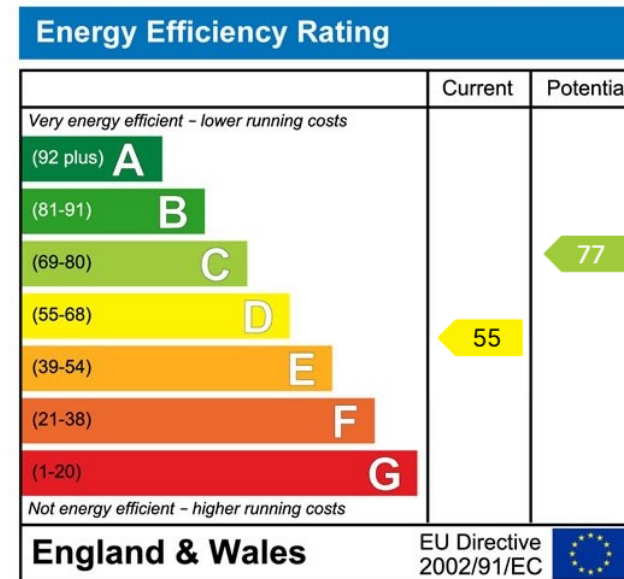

Visit us at  
[www.pooletownsend.co.uk](http://www.pooletownsend.co.uk)  
[enquiries@pooletownsend.co.uk](mailto:enquiries@pooletownsend.co.uk)

We are open  
 Monday – Friday 9.00 – 5.00  
 Saturday 9.00 – 1.00

Barrow 01229 811811  
 Ulverston 01229 588111  
 Grange 015395 33316  
 Kendal 01539 734455  
 Milnthorpe 015395 62044