



Charney Court, Grange-over-Sands, LA11 6DL

£275,000

🛏 2 🚿 1 🛋 1



- 2 Bed Detached Bungalow
- Elevated Location
- Views Across Morecambe Bay
- Spacious Lounge
- Bright And Airy Accommodation
- Driveway Parking
- Detached Garage
- Freehold
- Council Tax Band D
- NO UPPER CHAIN



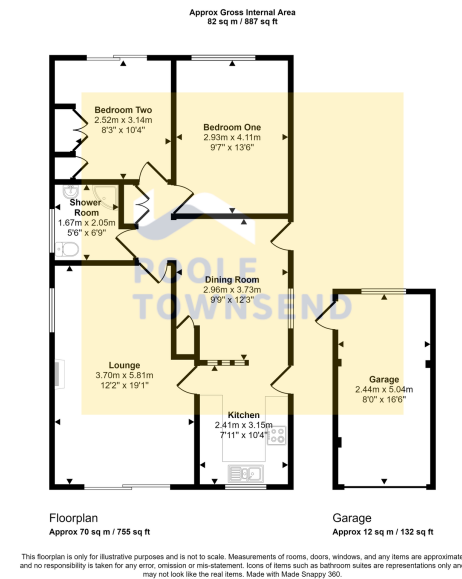

Nestled in an elevated location on the edge of the town centre and enjoying delightful views across Morecambe bay is this detached true bungalow. Naturally bright and airy and offering buyers an opportunity to update and personalise, the accommodation includes a spacious lounge with an electric fire and glazed doors opening onto the front garden, a dining room with access to a sleek kitchen, two double bedrooms and a shower room. Complete with ample driveway parking, a detached garage and an enclosed rear garden, this property must be viewed to be appreciated. No upper chain.

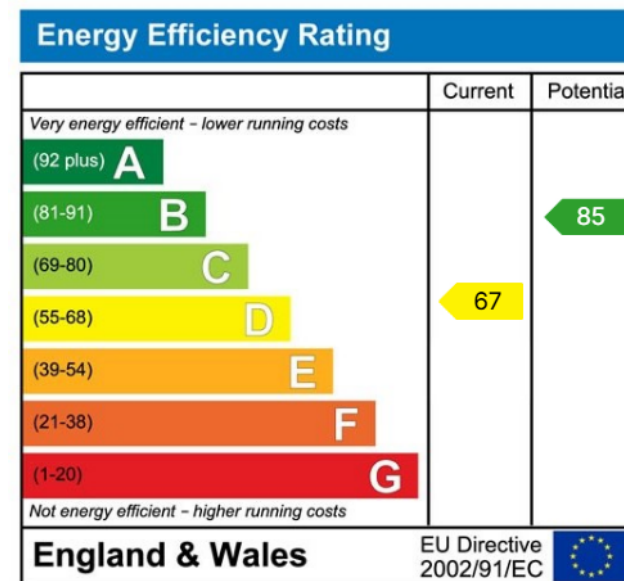

Visit us at
www.pooletownsend.co.uk
enquiries@pooletownsend.co.uk

We are open
 Monday – Friday 9.00 – 5.00
 Saturday 9.00 – 1.00

Barrow 01229 811811
 Ulverston 01229 588111
 Grange 015395 33316
 Kendal 01539 734455
 Milnthorpe 015395 62044