



**POOLE
TOWNSEND**

Moorside, Flookburgh, Grange over Sands

£225,000

3 1 1



- 3 Bedroomed Semi Detached • Elevated Position Home
- Views Across Open Countryside
- Lawned Gardens
- Council Tax Band B
- Local Occupancy Clause Applies
- Spacious Lounge & Open Plan Kitchen Diner
- Opportunity to Update and Personalise
- Freehold
- NO UPPER CHAIN



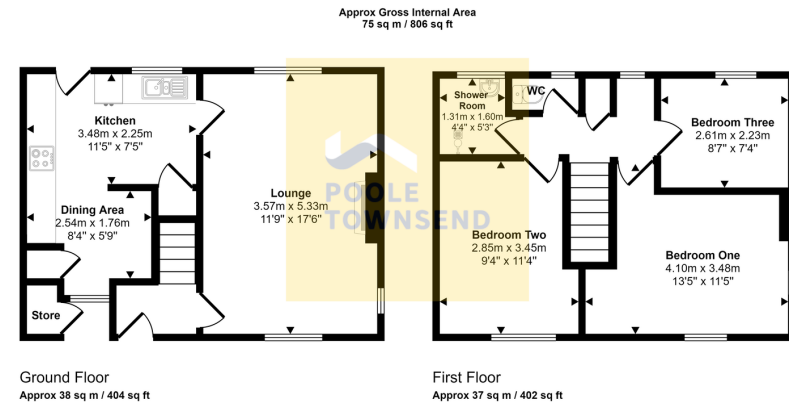

This floorplan is only for illustrative purposes and is not to scale. Measurements of rooms, doors, windows, and any items are approximate and no responsibility is taken for any error, omission or mis-statement. Icons of items such as bathroom suites are representations only and may not look like the real items. Made with Made Snappy 360.

Situated in an elevated position within the popular village of Flookburgh and enjoying attractive views out across open countryside and round to Humphrey Head, is this semi-detached home. Generously proportioned over two floors and surrounded by lawn gardens to three sides, the accommodation includes a full depth lounge with an electric fire, an open plan kitchen/diner, three good size bedrooms, a wet room and WC. Offered with no upper chain, this property provides a fantastic opportunity for buyers to update and personalise to own tastes and requirements. Local Occupancy Clause applies.

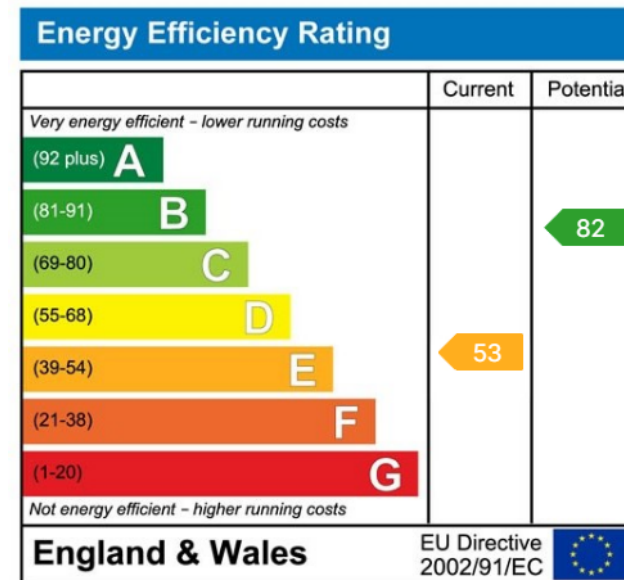

Visit us at
www.pooletownsend.co.uk
enquiries@pooletownsend.co.uk

We are open
 Monday – Friday 9.00 – 5.00
 Saturday 9.00 – 1.00

Barrow 01229 811811
 Ulverston 01229 588111
 Grange 015395 33316
 Kendal 01539 734455
 Milnthorpe 015395 62044