





# Town End Meadow, Cartmel, Grange over Sands £440,000

3 1 1





- Set within the Historic Village of Cartmel
- Popular Residential Development
- Detached Bungalow, Views to Hampsfell
- Lounge And Family Kitchen Diner
- 3 Bedrooms
- Colourful Planted borders
- Patio Seating Area
- NO UPPER CHAIN
- EPC rating: C
- Council Tax Band E



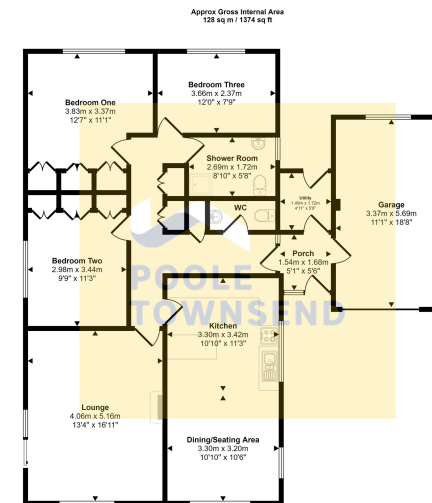

Floorplan

This floorplan is only for illustrative purposes and is not to scale. Measurements of rooms, doors, windows, and any items are approximate and no responsibility is taken for any error, omission or mis-statement. Some of items such as bathroom suites are representations only and may not look like the real items. Made with Snappy 360.

Situated in an exclusive residential development within the historic village of Cartmel is this superb, three bedroom detached bungalow. Surrounded by colourful planted borders and patio seating areas, this naturally bright property features a spacious lounge, a family kitchen/diner, three generous size bedrooms, a shower room and separate WC. With the added benefit of a useful utility area, ample storage cupboards, drive and integral garage, this property must be viewed to be appreciated. No Chain.

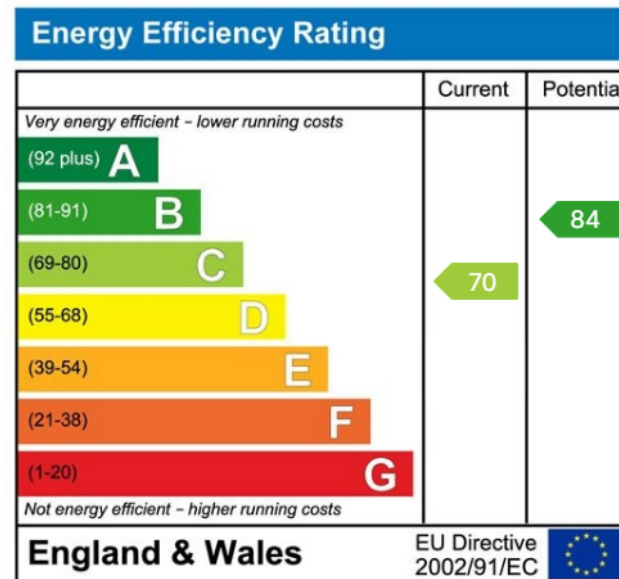

Visit us at  
[www.pooletownsend.co.uk](http://www.pooletownsend.co.uk)  
[enquiries@pooletownsend.co.uk](mailto:enquiries@pooletownsend.co.uk)

We are open  
 Monday – Friday 9.00 – 5.00  
 Saturday 9.00 – 1.00

Barrow 01229 811811  
 Ulverston 01229 588111  
 Grange 015395 33316  
 Kendal 01539 734455  
 Milnthorpe 015395 62044