



**POOLE
TOWNSEND**

Crown Hill, Main Street Grange Over Sands

£235,000

🛏️ 2 🪑 1 🚗 1



- Immaculately Presented
- Bright and Airy
- Centrally Located Second Floor Apartment
- Stair or Lift Access
- Spacious Living
- 2 Double Bedrooms
- Views Towards Morecambe Bay
- Allocated Parking Bay
- Leasehold, Council Tax Band D
- NO UPPER CHAIN



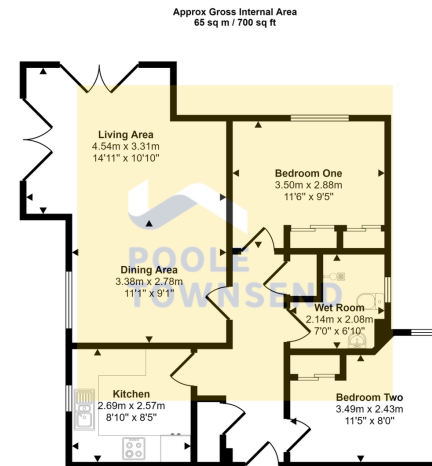

Floorplan

This floorplan is only for illustrative purposes and is not to scale. Measurements of rooms, doors, windows, and any items are approximate and no responsibility is taken for any error, omission or mis-statement. Icons of items such as bathroom suites are representations only and may not look like the real items. Made with Made Snappy 360.

Centrally located within the Edwardian coastal resort of Grange over Sands, is this immaculately presented, second floor apartment with views towards Morecambe bay. Naturally bright and airy throughout, the accommodation includes two double bedrooms with fitted wardrobes, a spacious living/dining room with Juliet balconies, a kitchen and wet room. With the added benefit of allocated parking, the shared use of visitors parking and communal gardens, this property must be viewed to be appreciated. No Chain.

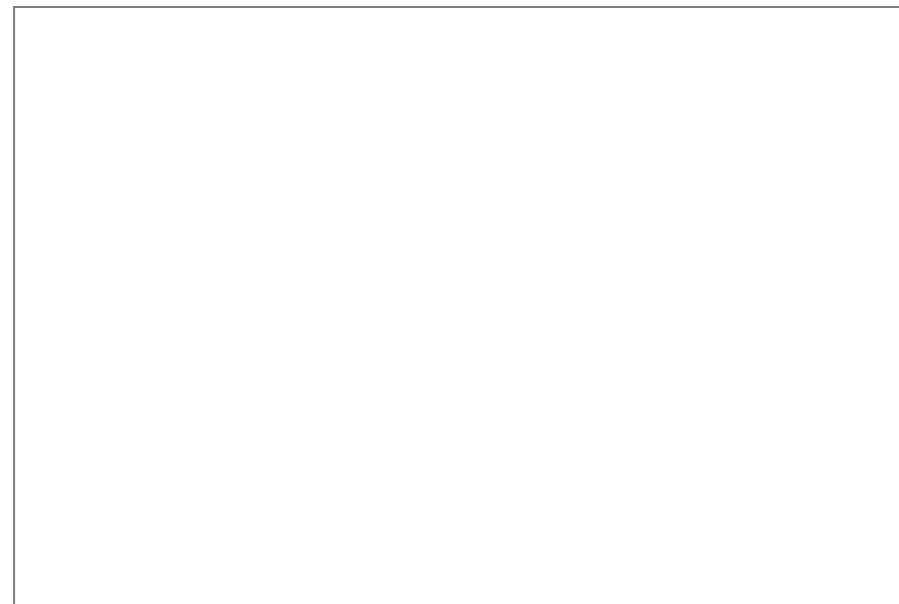

Visit us at
www.pooletownsend.co.uk
enquiries@pooletownsend.co.uk

We are open
 Monday – Friday 9.00 – 5.00
 Saturday 9.00 – 1.00

Barrow 01229 811811
 Ulverston 01229 588111
 Grange 015395 33316
 Kendal 01539 734455
 Milnthorpe 015395 62044