



**POOLE
TOWNSEND**

14 Strand Court, The Esplanade, Grange over Sands
£87,500

1 1 1



- Purpose Built Over 60s Development
- Double Bedroom
- Communal Lounge and Laundry
- Leasehold
- First Floor Apartment
- Convenient Central Location
- Overlooking Communal Gardens
- Council Tax Band B





Approx Gross Internal Area
41 sq m / 444 sq ft

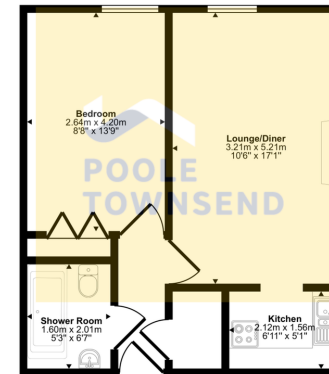

Floorplan

This floorplan is only for illustrative purposes and is not to scale. Measurements of rooms, doors, windows, and any items are approximate and no responsibility is taken for any error, omission or mis-statement. Icons of items such as bathroom suites are representations only and may not look like the real items. Made with Made Snappy 360.

Situated within a purpose built over 60s independent living development, is this attractively presented first floor apartment overlooking the communal gardens. Offering well-proportioned accommodation, the apartment includes a double bedroom, a modern fitted shower room and a bright lounge/diner with open access to a kitchen. Equipped with emergency pull cords and the use of the communal lounge, laundry and surrounding gardens, this apartment must be viewed to be appreciated.

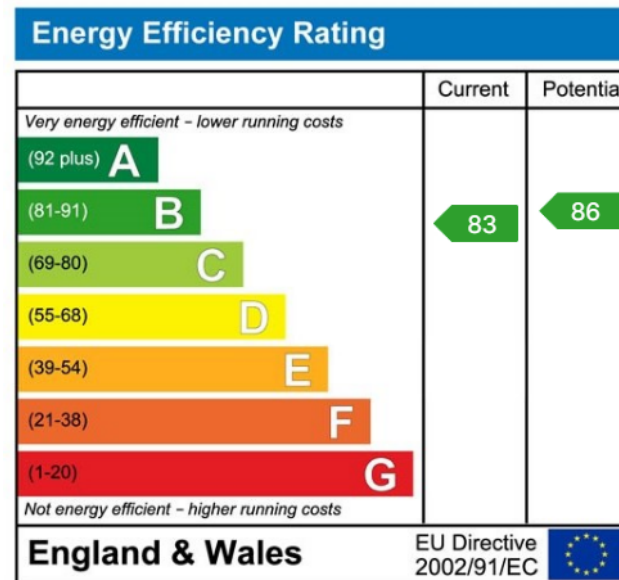

Visit us at
www.pooletownsend.co.uk
enquiries@pooletownsend.co.uk

We are open
 Monday – Friday 9.00 – 5.00
 Saturday 9.00 – 1.00

Barrow 01229 811811
 Ulverston 01229 588111
 Grange 015395 33316
 Kendal 01539 734455
 Milnthorpe 015395 62044