



**POOLE
TOWNSEND**

Kingslows, Dixon Wood Close, Lindale

£380,000

🛏️ 4 🚿 1 🚗 1



- Generous Corner Plot
- Bright Family Lounge
- Modern Kitchen Diner
- Integral Garage
- Freehold Council Tax Band
- 4 Bedroomed Detached House
- Dual Aspect Views
- Balcony
- Lawn And Patio Garden
- NO UPPER CHAIN



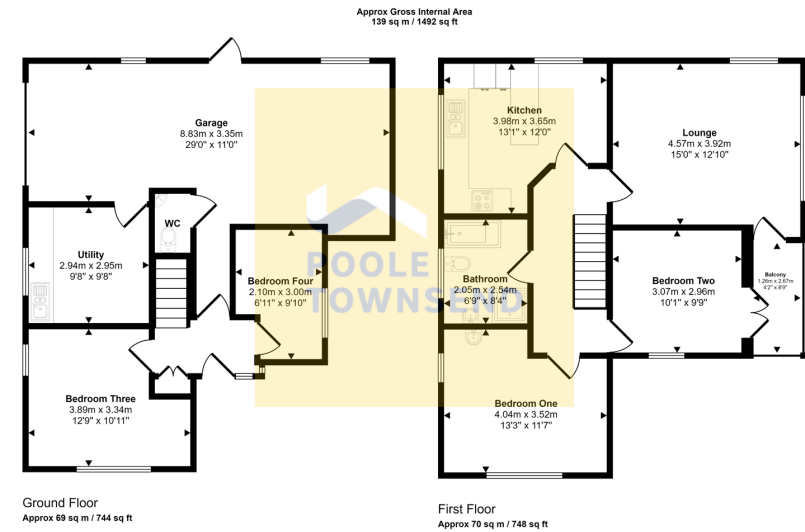

This floorplan is only for illustrative purposes and is not to scale. Measurements of rooms, doors, windows, and any items are approximate and no responsibility is taken for any error, omission or mis-statement. Icons of items such as bathroom suites are representations only and may not look like the real items. Made with Made Spappy 360.

Occupying a generous corner plot within the centre of Lindale is this fabulous family home. Enjoying open aspect views across neighbouring fields and farmland, this deceptively spacious property boasts a bright lounge with access to a sheltered balcony, a modern kitchen/diner, four bedrooms and a four piece bathroom. Complete with off road parking for several vehicles, a large integral garage with separate utility and WC and surrounding lawn and patio gardens, this property must be viewed to be appreciated. No Chain.

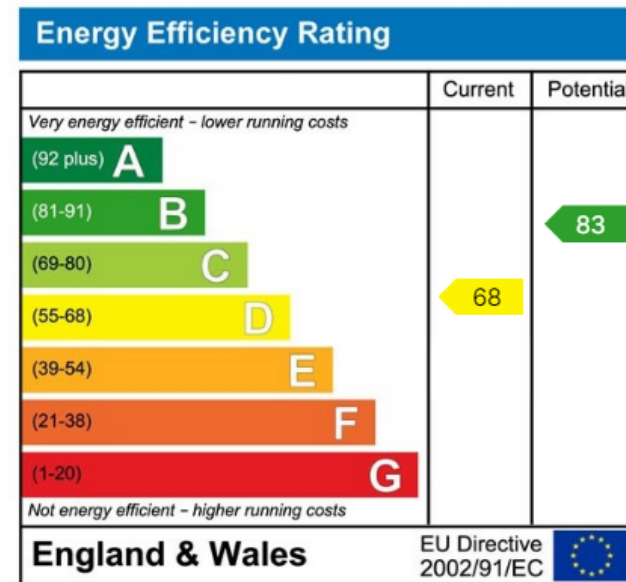

Visit us at
www.pooletownsend.co.uk
enquiries@pooletownsend.co.uk

We are open
 Monday – Friday 9.00 – 5.00
 Saturday 9.00 – 1.00

Barrow 01229 811811
 Ulverston 01229 588111
 Grange 015395 33316
 Kendal 01539 734455
 Milnthorpe 015395 62044