



**POOLE
TOWNSEND**

6 Charney Court, Grange over Sands

£335,000

🛏️ 2 🪑 1 🚗 1



- Views across Morecambe Bay
- Popular and private residential area situated in an elevated location
- The two double bedrooms overlook the rear garden
- Established garden with colourful shrubs and bushes
- Freehold
- Detached true bungalow
- Bright and spacious lounge, kitchen/diner, a fabulous social dining area and
- ~~Work space~~ ~~work space~~ which extends across the back, providing a delightful area for alfresco
- ~~Simple and entertaining~~ ~~simple and entertaining~~ and a detached garage,



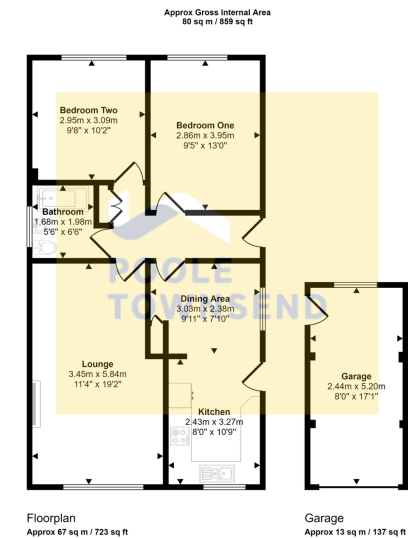

This floorplan is only for illustrative purposes and is not to scale. Measurements of rooms, doors, windows, and any items are approximate and no responsibility is taken for any error, omission or mis-statement. Icons of items such as bathroom suites are representations only and may not look like the real items. Made with Made2Happy 360.

Situated in an elevated location on the edge of the town centre and enjoying delightful views across Morecambe bay is this detached true bungalow. Featuring a bright lounge, a spacious kitchen/diner with fitted and included appliances, two double bedrooms and a sleek bathroom. Complete with low maintenance front and rear gardens, ample driveway parking and a detached garage, this property must be viewed to be appreciated. No upper chain.

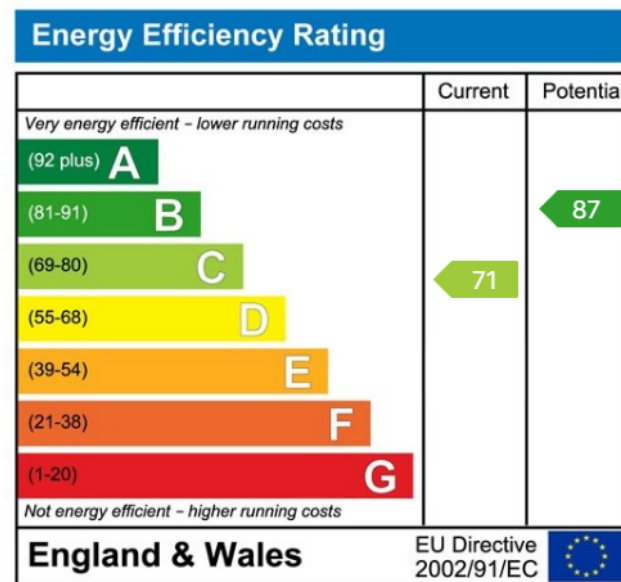

Visit us at
www.pooletownsend.co.uk
enquiries@pooletownsend.co.uk

We are open
 Monday – Friday 9.00 – 5.00
 Saturday 9.00 – 1.00

Barrow 01229 811811
 Ulverston 01229 588111
 Grange 015395 33316
 Kendal 01539 734455
 Milnthorpe 015395 62044