



**POOLE
TOWNSEND**

Flat 2 , 2 Thornfield Road, Grange over Sands

£120,000

1 1 1



- 1 Bedroomed Apartment
- Peaceful and Private Residential Location
- Conveniently Situated
- Attractively Presented
- Open Plan Living Kitchen
- Double Bedroom
- Private Lawned Garden
- Leasehold
- Council Tax Band A
- Must be Viewed to be Appreciated



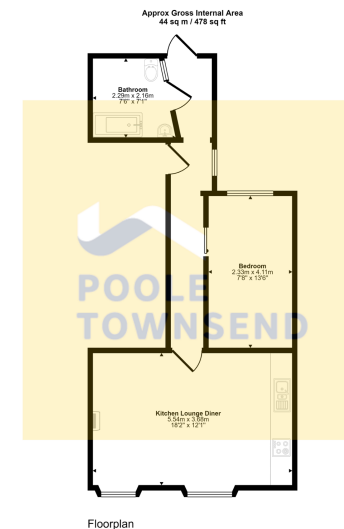

This floorplan is only for illustrative purposes and is not to scale. Measurements of rooms, doors, windows, and any items are approximate and no responsibility is taken for any error, omission or mis-statement. Icons of items such as bathroom suites are representations only and may not look like the real items. Made with Made Guppy 360.

Situated in a peaceful and private residential location, is this perfectly proportioned first floor flat, with glimpses of Morecambe bay. Conveniently placed to all of Grange's amenities and services, the property provides an ideal main residence or bolt hole within the Lakes. Attractively presented but with an opportunity to update and personalise, the accommodation includes an open plan living kitchen, double bedroom and three piece bathroom. With the added benefit of a private lawn garden, this property must be viewed to be appreciated.

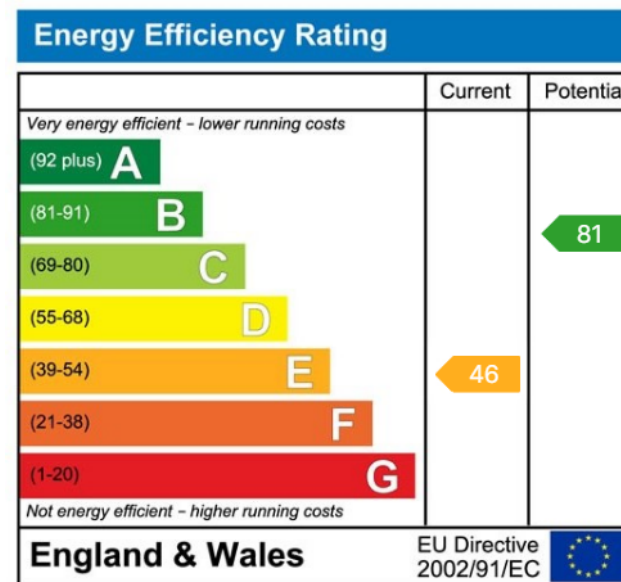

Visit us at
www.pooletownsend.co.uk
enquiries@pooletownsend.co.uk

We are open
 Monday – Friday 9.00 – 5.00
 Saturday 9.00 – 1.00

Barrow 01229 811811
 Ulverston 01229 588111
 Grange 015395 33316
 Kendal 01539 734455
 Milnthorpe 015395 62044