



**POOLE  
TOWNSEND**



Grayrigge Court, Kents Bank Road, Grange over sands  
£97,500

1 1 1





- Lift access
- Within walking distance of local amenities.
- Popular over 60s residential development
- Well-presented, bright and airy third floor apartment.
- Council Tax Band B
- Shared use of the surrounding communal garden
- Communal lounge with views and laundry facility
- Large double bedroom with fitted wardrobes
- One of The Larger 1 Bedroomed Apartments
- Leasehold Property



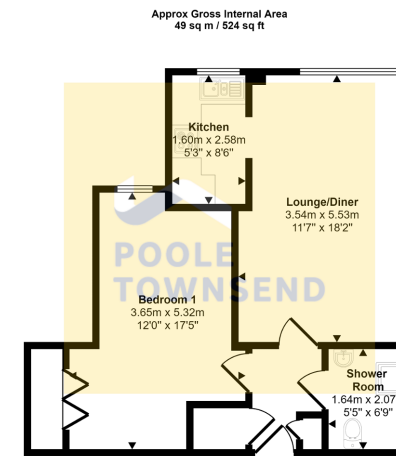

Floorplan

This floorplan is only for illustrative purposes and is not to scale. Measurements of rooms, doors, windows, and any items are approximate and no responsibility is taken for any error, omission or mis-statement. Icons of items such as bathroom suites are representations only and may not look like the real items. Made with Made Snappy 360.

Situated within the popular Grayrigge Court development, is this well-presented, bright and airy third floor apartment. Offering generously proportioned accommodation which includes a large double bedroom with fitted wardrobes, a modern shower room, a lounge/diner with fixed electric fire and a kitchen. Complete with the shared use of the communal garden, lounge and laundry facilities, this property must be viewed to be appreciated. Please note this property is for over 60's only.

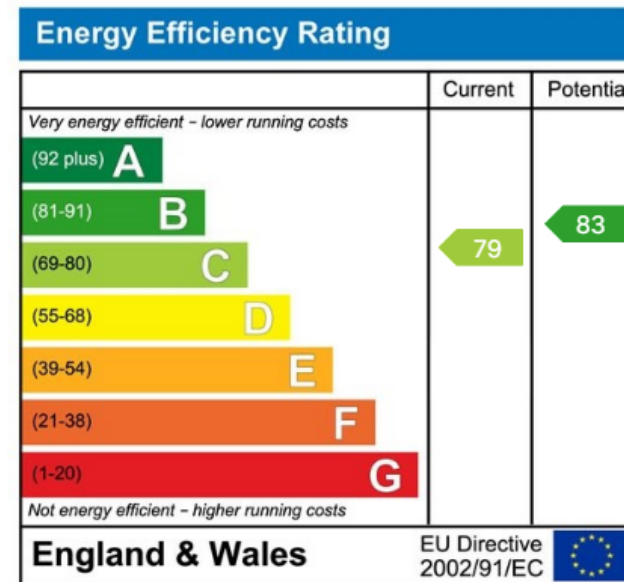

Visit us at  
[www.pooletownsend.co.uk](http://www.pooletownsend.co.uk)  
[enquiries@pooletownsend.co.uk](mailto:enquiries@pooletownsend.co.uk)

We are open  
 Monday – Friday 9.00 – 5.00  
 Saturday 9.00 – 1.00

Barrow 01229 811811  
 Ulverston 01229 588111  
 Grange 015395 33316  
 Kendal 01539 734455  
 Milnthorpe 015395 62044