



**POOLE  
TOWNSEND**

# Hampsfell Road, Grange-over-sands, LA11 6AZ

£105,000

1 1 1





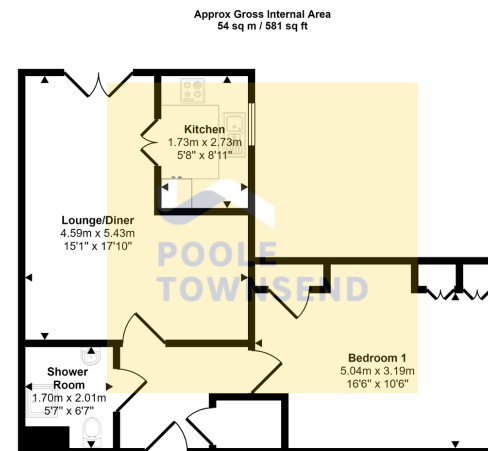

Floorplan

This floorplan is only for illustrative purposes and is not to scale. Measurements of rooms, doors, windows, and any items are approximate and no responsibility is taken for any error, omission or mis-statement. Icons of items such as bathroom suites are representations only and may not look like the real items. Made with Made Snappy 360.

Situated within a popular over 60s independent living development within the centre of Grange, is this attractively presented second floor apartment. Offering generous size accommodation, the apartment includes a spacious double bedroom with built in wardrobes, an open plan lounge/diner with views over the town and to Morecambe bay, and a modern fitted kitchen and shower room. Equipped with emergency pull cords and the use of the communal lounge, laundry and surrounding gardens, this apartment must be viewed to be appreciated. **Please Note: An over 60s development (or if two people buying, the second buyer must be over 55). No Chain.**

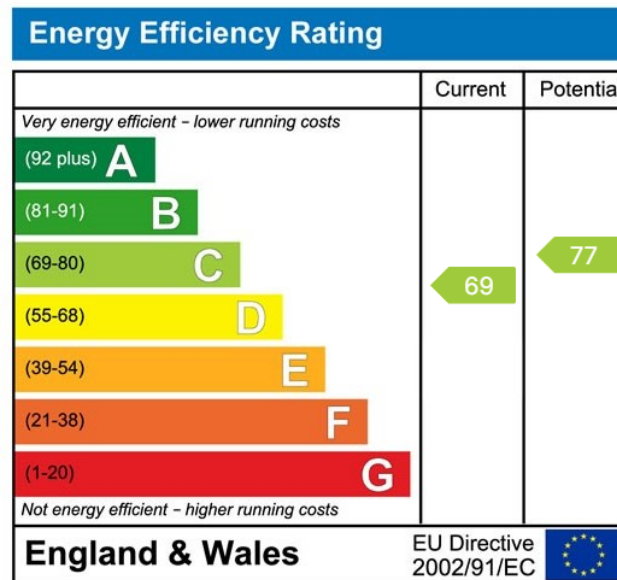

Visit us at  
[www.pooletownsend.co.uk](http://www.pooletownsend.co.uk)  
[enquiries@pooletownsend.co.uk](mailto:enquiries@pooletownsend.co.uk)

We are open  
 Monday – Friday 9.00 – 5.00  
 Saturday 9.00 – 1.00

Barrow 01229 811811  
 Ulverston 01229 588111  
 Grange 015395 33316  
 Kendal 01539 734455  
 Milnthorpe 015395 62044