



**POOLE
TOWNSEND**

23 Strand Court The Esplanade, Grange-over-sands, LA11 7HH

£105,000

1 1 1



- INVESTMENT BUYERS ONLY • Leasehold property
- Council tax band B
- Bright Lounge
- Second floor apartment
- Laundry
- Double Bedroom
- Emergency Pull Cords
- Communal Lounge
- Please Note the apartment will be sold with a tenant in situ





Approx Gross Internal Area
44 sq m / 476 sq ft

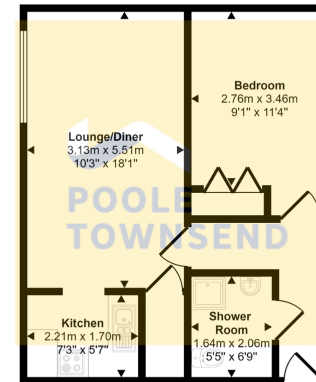

Floorplan

This floorplan is only for illustrative purposes and is not to scale. Measurements of rooms, doors, windows, and any items are approximate and no responsibility is taken for any error, omission or mis-statement. Icons of items such as bathroom suites are representations only and may not look like the real items. Made with Made Snappy 360.

INVESTMENT BUYERS ONLY. Situated within a purpose built over 60s independent living development, is this attractively presented second floor apartment. Offering well-proportioned accommodation, the apartment includes a double bedroom, a bright lounge/diner with open archway to a kitchen and a shower room. Equipped with emergency pull cords and the use of the communal lounge, laundry and surrounding gardens, this apartment must be viewed to be appreciated. **Please Note the apartment will be sold with a tenant in situ.**

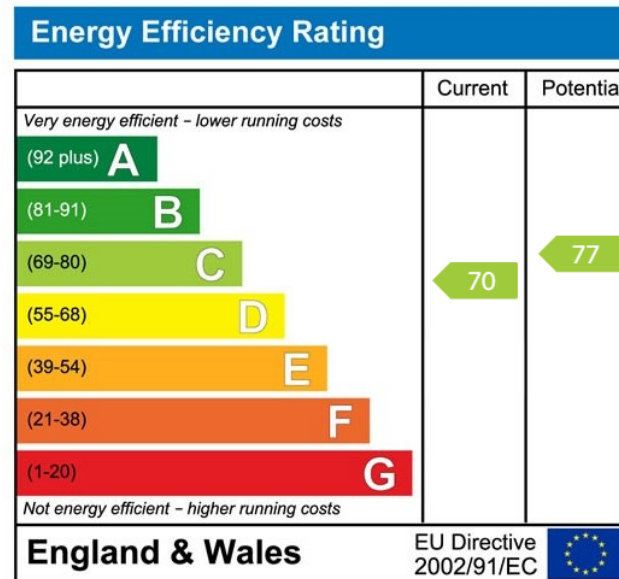

Visit us at
www.pooletownsend.co.uk
enquiries@pooletownsend.co.uk

We are open
 Monday – Friday 9.00 – 5.00
 Saturday 9.00 – 1.00

Barrow 01229 811811
 Ulverston 01229 588111
 Grange 015395 33316
 Kendal 01539 734455
 Milnthorpe 015395 62044