



**POOLE
TOWNSEND**

Flat 2 Avondale, 88 Kentsford Road , Grange over Sands
£200,000

🛏️ 2 🍽️ 1 🚗 1



- Spacious First Floor Flat
- 2 Bedrooms
- Bright & Airy
- Peaceful Location
- Period Conversion
- Views across Morecambe Bay
- Viewing Recommended



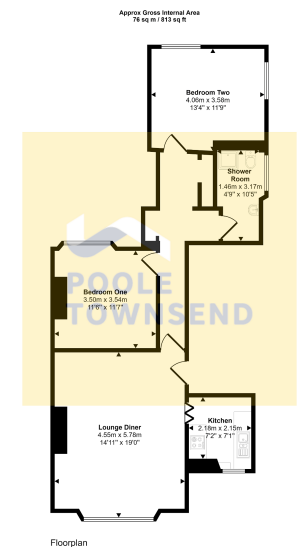

This floorplan is only for illustrative purposes and is not to scale. Measurements of rooms, doors, windows, and any items are approximate and no responsibility is taken for any error, omission or mis-statement. Areas of items such as built-in furniture are representative only and may not look like the real items. Made with Make Design 300.

Situated in a peaceful residential location on the fringes of Grange-over-Sands, is this deceptively spacious and wonderfully light, first floor apartment. Forming part of a period conversion, the apartment includes an open plan lounge diner with ornate corning and open fireplace, a kitchen, two double bedrooms and a modern shower room. Enjoying elevated views across Morecambe Bay and beyond, this property will appeal to those seeking a primary residence or second home. No Chain.

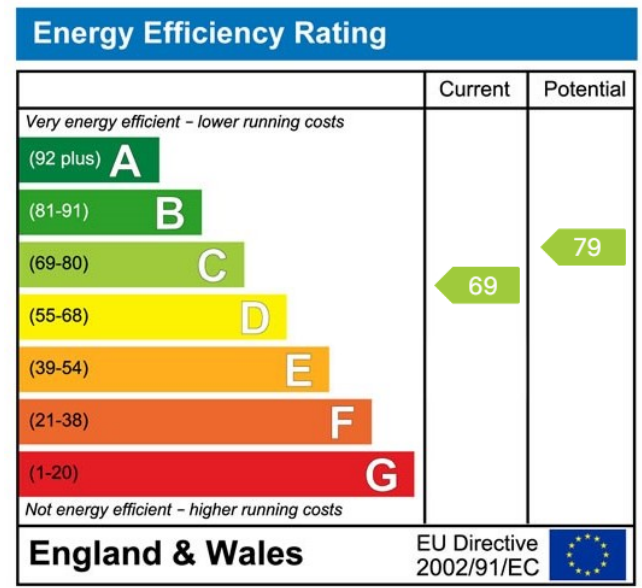

Visit us at
www.pooletownsend.co.uk
enquiries@pooletownsend.co.uk

We are open
 Monday – Friday 9.00 – 5.00
 Saturday 9.00 – 1.00

Barrow 01229 811811
 Ulverston 01229 588111
 Grange 015395 33316
 Kendal 01539 734455
 Milnthorpe 015395 62044