



**POOLE  
TOWNSEND**



Milnthorpe Road, Kendal, LA9 5AS

£160,000

🛏 2 🚿 1 🛋 1





- First Floor Flat
- Beautifully Presented Accommodation
- New Kitchen
- 2 Double Bedrooms
- Private Parking
- Communal Drying Area
- Ideal First Home / Investment
- Popular Residential Area
- Tenure: Leasehold
- Council Tax Band: A





Conveniently located within walking distance of the town centre, this deceptively spacious first-floor flat is presented in move-in condition—ideal for first-time buyers, couples, or rental investors. Naturally bright and airy, the accommodation comprises two generous double bedrooms, a large living room, and a modern kitchen/diner and bathroom. The property also benefits from a communal drying area and private parking. Early viewing is highly recommended to fully appreciate all this attractive flat has to offer.

Approx Gross Internal Area  
68 sq m / 734 sq ft

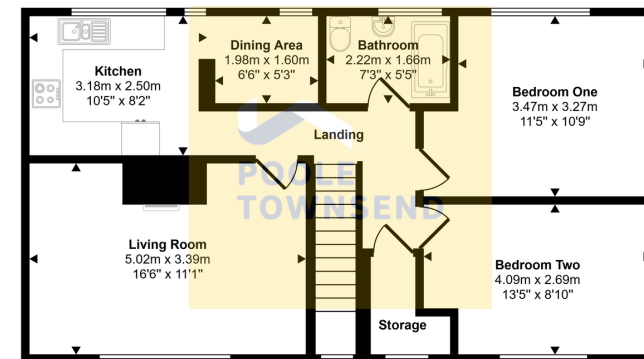

First Floor

This floorplan is only for illustrative purposes and is not to scale. Measurements of rooms, doors, windows, and any items are approximate and no responsibility is taken for any error, omission or mis-statement. Icons of items such as bathroom suites are representations only and may not look like the real items. Made with Snappy 360.

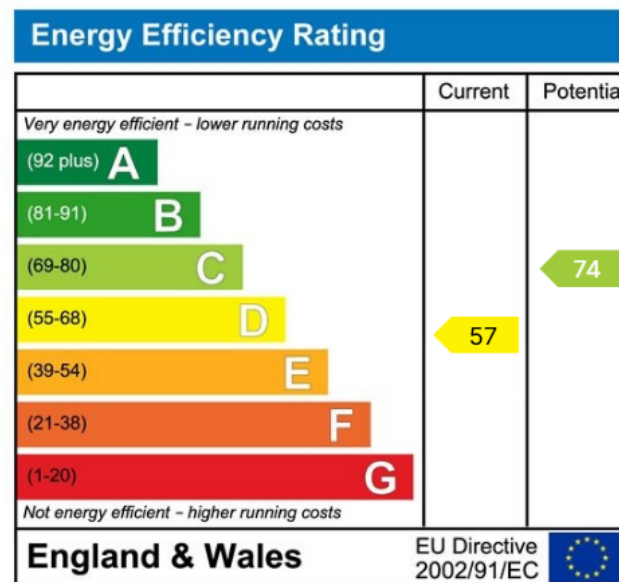

Visit us at  
[www.pooletownsend.co.uk](http://www.pooletownsend.co.uk)  
[enquiries@pooletownsend.co.uk](mailto:enquiries@pooletownsend.co.uk)

We are open  
 Monday – Friday 9.00 – 5.00  
 Saturday 9.00 – 1.00

Barrow 01229 811811  
 Ulverston 01229 588111  
 Grange 015395 33316  
 Kendal 01539 734455  
 Milnthorpe 015395 62044