



**POOLE  
TOWNSEND**



54 Hayclose Crescent,  
£245,000

3 1 2





- Naturally Bright Family Home • Sought After Residential Area

- Spacious Lounge

- Well Appointed Kitchen

- Two Generously Sized Double Rooms

- Practical Conservatory

- Private Enclosed Patio

- Useful Garden Store

- EPC Rating: C

- Council Tax Band:



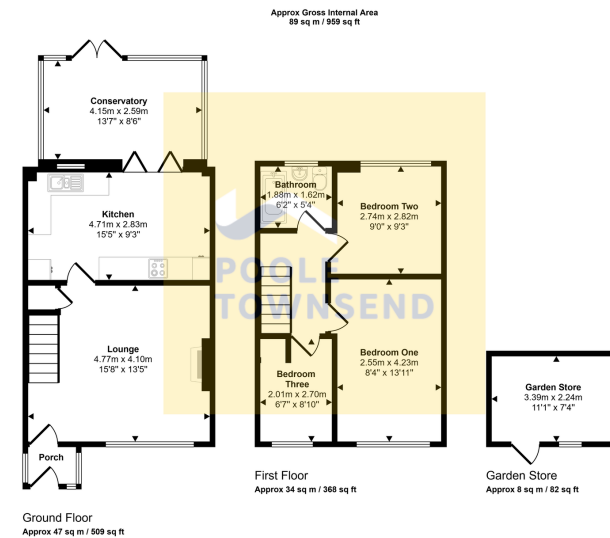

This floorplan is only for illustrative purposes and is not to scale. Measurements of rooms, doors, windows, and any items are approximate and no responsibility is taken for any error, omission or mis-statement. Icons of items such as bathroom suites are representations only and may not look like the real items. Made with Made Snappy 360.

Situated in a peaceful spot within one of Kendal's most sought-after residential areas, this generously proportioned and naturally bright family home has been thoughtfully extended to offer versatile and spacious ground-floor accommodation. The ground floor features a welcoming lounge and a family-sized kitchen/diner, seamlessly connecting to a large conservatory via glazed bi-fold doors. The conservatory opens out onto a private, enclosed patio garden, ideal for entertaining or relaxing with family. Upstairs, the property offers three well-proportioned bedrooms and a family bathroom, all designed with comfort and practicality in mind. Externally, the home is complemented by a lawn front garden, a private rear patio, and a useful garden store, providing both curb appeal and functional outdoor space.

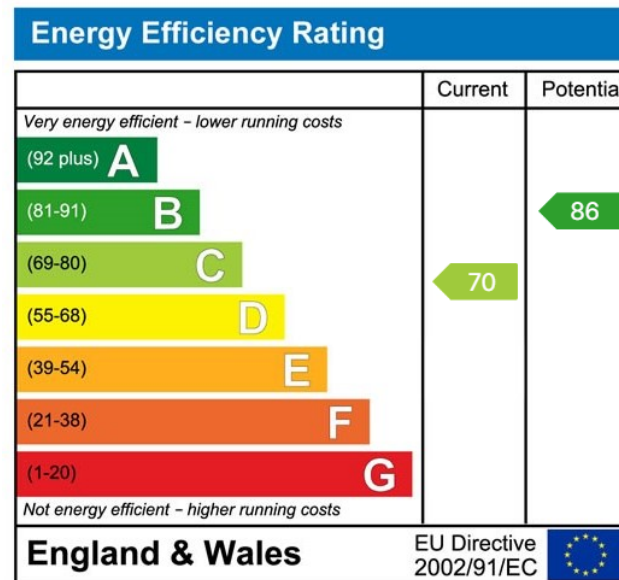

Visit us at  
[www.pooletownsend.co.uk](http://www.pooletownsend.co.uk)  
[enquiries@pooletownsend.co.uk](mailto:enquiries@pooletownsend.co.uk)

We are open  
 Monday – Friday 9.00 – 5.00  
 Saturday 9.00 – 1.00

Barrow 01229 811811  
 Ulverston 01229 588111  
 Grange 015395 33316  
 Kendal 01539 734455  
 Milnthorpe 015395 62044