



**POOLE  
TOWNSEND**

# Sparrowmire Lane, Kendal, Westmorland And Furness, LA9 5PU

£210,000

2 1 0



- Attractively Presented End-Terraced Home
- Modern Kitchen/ Diner
- Split Level Patio Garden
- Convenient Outbuilding for Storage
- EPC Rating: D
- Spacious & Bright Lounge
- Two Generous Double Rooms
- On Street Parking
- Potential to Extend or Develop
- Council Tax Band: B

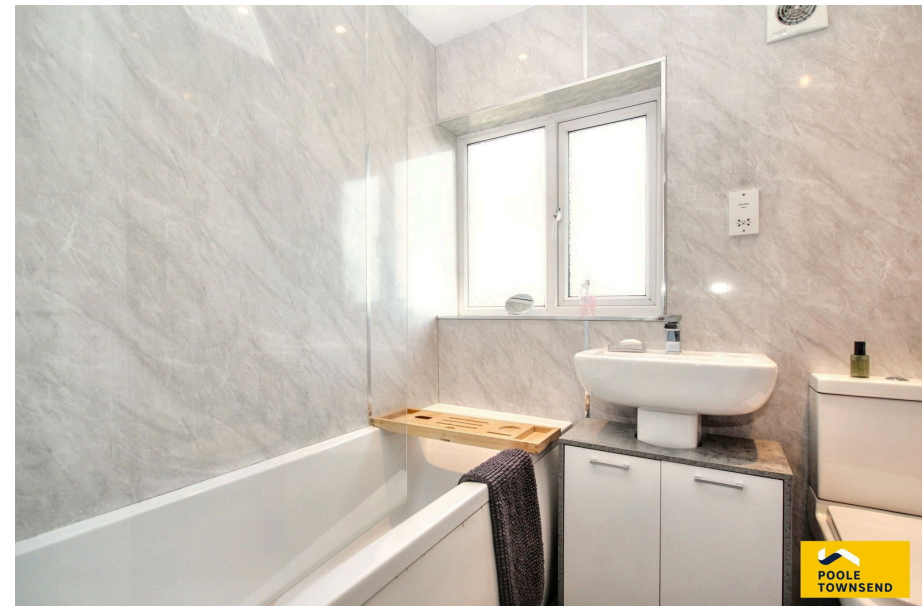

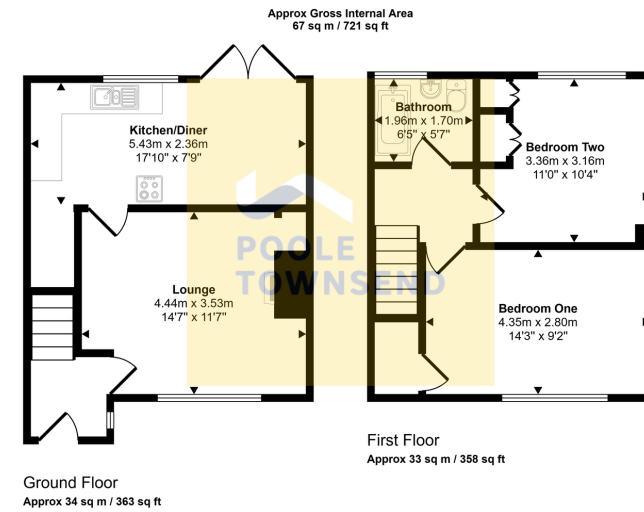

Nestled in a popular residential area on the northern edge of the town centre, this attractively presented end-terraced home offers spacious and light-filled accommodation throughout. The property boasts two generous double bedrooms, a modern kitchen and bathroom, and a cosy lounge complete with a charming multi-fuel stove, perfect for relaxing evenings. Externally, you'll find on-street parking, and a patio area to the front, and to the rear, a generous split-level patio garden, along with a useful outbuilding. With clear potential to extend or develop (subject to the necessary permissions), this home offers an exciting opportunity and must be viewed to be fully appreciated.

Visit us at  
[www.pooletownsend.co.uk](http://www.pooletownsend.co.uk)  
[enquiries@pooletownsend.co.uk](mailto:enquiries@pooletownsend.co.uk)

We are open  
 Monday – Friday 9.00 – 5.00  
 Saturday 9.00 – 1.00

Barrow 01229 811811  
 Ulverston 01229 588111  
 Grange 015395 33316  
 Kendal 01539 734455  
 Milnthorpe 015395 62044