



**POOLE
TOWNSEND**

Heron Close, Kendal

£200,000

3 1 1



- Shared Equity Property
- End Terraced House
- Off Road Parking
- Local Occupancy Clause Applies
- Council Tax Band: C
- Offered At 80% Of Market Value
- 3 Bedrooms
- Garden
- No Chain
- Tenure: Leasehold



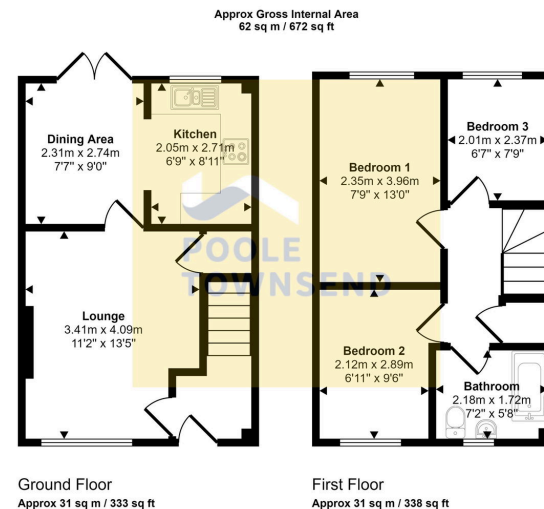

This floorplan is only for illustrative purposes and is not to scale. Measurements of rooms, doors, windows, and any items are approximate and no responsibility is taken for any error, omission or mis-statement. Icons of items such as bathroom suites are representations only and may not look like the real items. Made with Made Snappy 360.

This is an immaculately presented shared equity home, offered at 80% of the market value, nicely upgraded including new heaters (2023), featuring an array of solar PV panels to the South facing roof at the rear, and triple glazing. The property is light and airy and offers a comfortable size lounge with an open plan dining kitchen that has double doors opening into a sunny garden. The first floor provides two double bedrooms, a single bedroom and a three-piece bathroom with a shower installed over the bath. There is further garden to the front and side of the property and allocated off-road parking. Local occupancy restrictions apply.

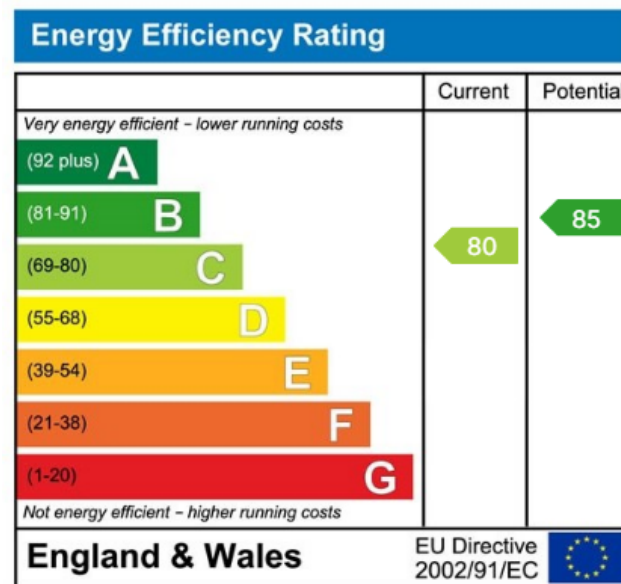

Visit us at
www.pooletownsend.co.uk
enquiries@pooletownsend.co.uk

We are open
 Monday – Friday 9.00 – 5.00
 Saturday 9.00 – 1.00

Barrow 01229 811811
 Ulverston 01229 588111
 Grange 015395 33316
 Kendal 01539 734455
 Milnthorpe 015395 62044