



**POOLE
TOWNSEND**

Moore Field Close, Kendal

£170,000

🛏️ 2 🪑 1 🚗 1



- No Chain
- Quiet Cul-De-Sac Location
- 2 Bedrooms
- Lounge/Diner
- Neutral Decor Throughout
- Off Road Parking
- Fully Enclosed Garden
- Close To A Wide Range Of Amenities
- Council Tax Band: B
- Tenure: Freehold





Approx Gross Internal Area
46 sq m / 497 sq ft

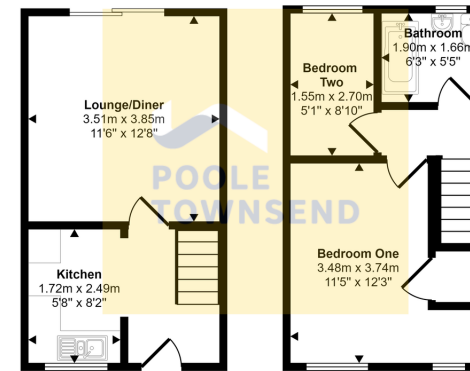

Ground Floor
Approx 23 sq m / 247 sq ft

First Floor
Approx 23 sq m / 250 sq ft

This floorplan is only for illustrative purposes and is not to scale. Measurements of rooms, doors, windows, and any items are approximate and no responsibility is taken for any error, omission or mis-statement. Icons of items such as bathroom suites are representations only and may not look like the real items. Made with Made Snappy 360.

Nestled on the edge of Kendal in a quiet cul-de-sac is this generously proportioned mid-terraced home. Naturally bright and airy over two floors the accommodation includes a modern kitchen, a lounge/diner with access to the enclosed rear garden, alongside two bedrooms and a family bathroom. An ideal home for a variety of buyers. No Chain.

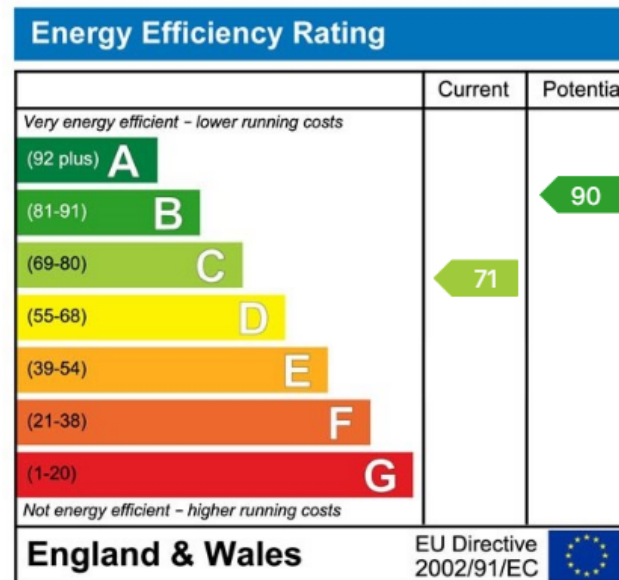

Visit us at
www.pooletownsend.co.uk
enquiries@pooletownsend.co.uk

We are open
 Monday – Friday 9.00 – 5.00
 Saturday 9.00 – 1.00

Barrow 01229 811811
 Ulverston 01229 588111
 Grange 015395 33316
 Kendal 01539 734455
 Milnthorpe 015395 62044