



**POOLE  
TOWNSEND**



# Lakesway Holiday Home & Lodge Park, 16 Topiary Way, Sampool Lane, Levens

£45,000

🛏️ 2 🍽️ 2 🚗 1





- Detached Lodge
- 2 Bedrooms
- 2 Bathrooms
- Beautifully Presented Accommodation
- Decked Seating Area
- Private Parking
- Use Of The Park's Facilities
- Stunning Rural Views
- Council Tax Band: N/A
- Tenure: Leasehold



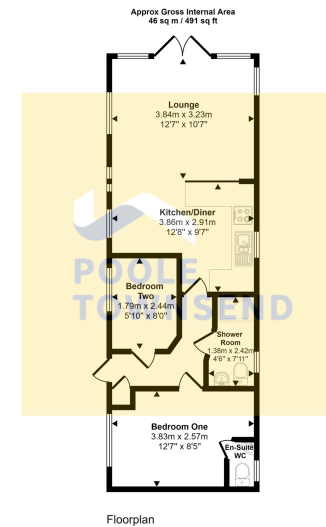

This floorplan is only for illustrative purposes and is not to scale. Measurements of rooms, doors, windows, and any items are approximate and no responsibility is taken for any error, omission or mis-statement. Items of items such as bathroom suites are representations only and may not look like the real items. Made with Made Snappy 360.

Situated to the edge of the Lake District National Park and bordering onto open fields and farmland is this attractively presented detached lodge. Perfectly proportioned this home from home lodge consists of two bedrooms, one with an en-suite WC facility, a separate shower room and an open plan living room with fitted kitchen and glazed doors opening out onto decked seating area. With the added benefit of private parking and the use of the park's facilities, this lodge must be viewed to be appreciated. **Please Note: For holiday use only. 12 month permitted access. Not to be used as a permanent residence.**

Visit us at  
[www.pooletownsend.co.uk](http://www.pooletownsend.co.uk)  
[enquiries@pooletownsend.co.uk](mailto:enquiries@pooletownsend.co.uk)

We are open  
 Monday – Friday 9.00 – 5.00  
 Saturday 9.00 – 1.00

Barrow 01229 811811  
 Ulverston 01229 588111  
 Grange 015395 33316  
 Kendal 01539 734455  
 Milnthorpe 015395 62044