



**POOLE
TOWNSEND**

Lingmoor Rise, Kendal

£120,000

🛏️ 1 🚿 1 🚻 1



- Bright and Airy Apartment
- Double Bedroom
- Useful Storage Cupboard
- Located in a Desirable Residential Area
- Council Tax Band: A
- Large Lounge Diner
- Neutral Bathroom Suite
- Communal Parking Area
- Ideal First-Time-Buy or Rental Investment
- Tenure: Leasehold





Approx Gross Internal Area
46 sq m / 497 sq ft

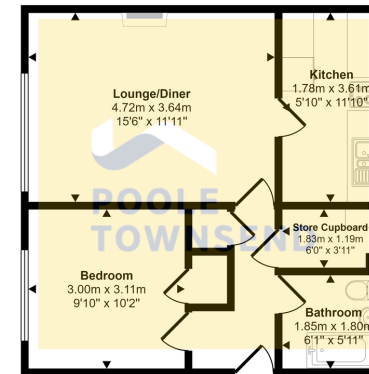

Floorplan

This floorplan is only for illustrative purposes and is not to scale. Measurements of rooms, doors, windows, and any items are approximate and no responsibility is taken for any error, omission or mis-statement. Icons of items such as bathroom suites are representations only and may not look like the real items. Made with Made Snappy 360.

Situated at the head of a peaceful residential cul-de-sac, is this perfectly proportioned first floor flat. Naturally bright and airy, the accommodation includes a lounge/diner, a kitchen, a double bedroom and a bathroom. With the added advantage of a large storage cupboard and a loft, this property provides a fantastic opportunity for first time buyers, couples or rental investment to update and personalise to own tastes and requirements. No Chain.

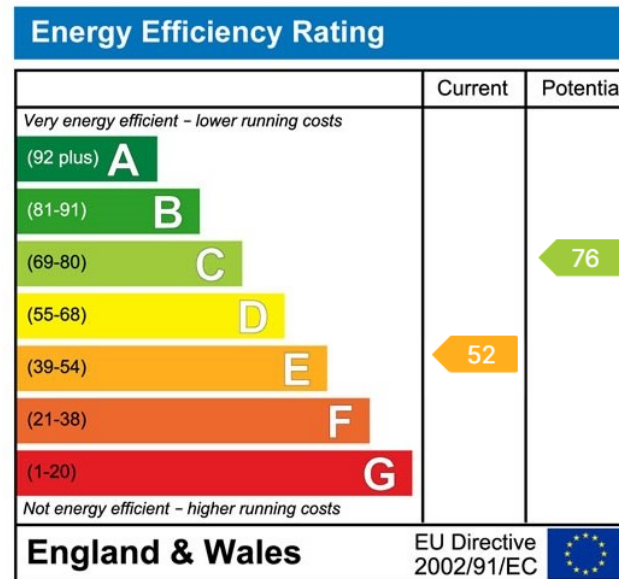

Visit us at
www.pooletownsend.co.uk
enquiries@pooletownsend.co.uk

We are open
 Monday – Friday 9.00 – 5.00
 Saturday 9.00 – 1.00

Barrow 01229 811811
 Ulverston 01229 588111
 Grange 015395 33316
 Kendal 01539 734455
 Milnthorpe 015395 62044