



**POOLE
TOWNSEND**

Limefitt Holiday Park, Windermere

Offers In Region Of £97,500

3 2 1



- Bright, Modern Lodge
- Three Bedrooms
- Master with En-Suite
- Great Sized Decking
- Beautiful Scenic Walks Nearby
- Spacious Open Plan Living Area
- Modern Bathroom Suite
- Walk-in Wardrobe
- Peaceful Lake District Location
- Close to Bowness-on-Windermere



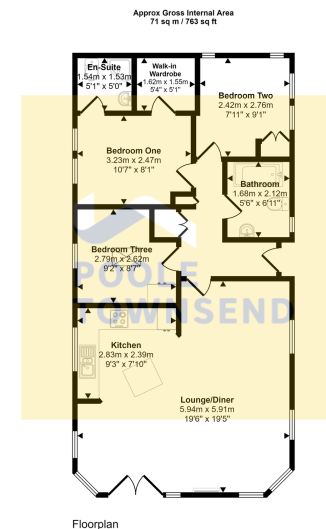

This floorplan is only for illustrative purposes and is not to scale. Measurements of rooms, doors, windows, and any items are approximate and no responsibility is taken for any error, omission or mis-statement. Icons of items such as bathroom suites are representations only and may not look like the real items. Made with Made Snappy 360.

Nestled within the tranquil Troutbeck valley, north of Windermere, is this impressive Lissett Utopia 2009 40ft X 20ft lodge. Occupying an peaceful location within the Limefitt Holiday Park and enjoying picturesque views to surrounding Lakeland fells, the lodge features a spacious, open plan living space with electric fire and a modern fitted kitchen with integrated appliances, a modern fitted bathroom and three generous size bedrooms, with an en-suite and walk in wardrobe to the master suite. With the added advantage of parking for two cars, a decked seating area and access to site facilities, this lodge must be viewed to be appreciated. No Chain.



Visit us at
www.pooletownsend.co.uk
enquiries@pooletownsend.co.uk

We are open
 Monday – Friday 9.00 – 5.00
 Saturday 9.00 – 1.00

Barrow 01229 811811
 Ulverston 01229 588111
 Grange 015395 33316
 Kendal 01539 734455
 Milnthorpe 015395 62044