



**POOLE  
TOWNSEND**

# Benson Lodge Lodge 17, Lightwater Tarns, Selside

£65,000

🛏️ 2 🪑 2 🚗 1



- Generous Two Bed Lodge
- Two Bathrooms
- Situated on the Edge of the Beautiful Lake District
- Lovely Outside Space
- Council Tax Band: NA
- Open Plan Living Space
- Parking for Several Cars
- Countryside Views
- No Chain
- Tenure: Leasehold



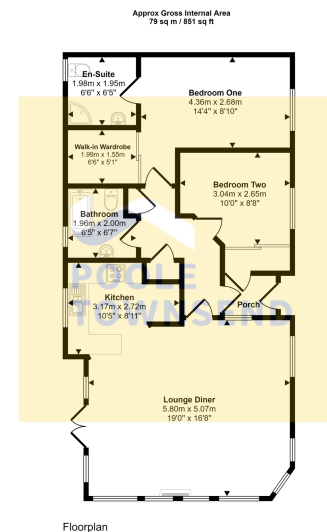

This floorplan is only for illustrative purposes and is not to scale. Measurements of rooms, doors, windows, and any items are approximate and no responsibility is taken for any error, omission or mis-statement. Icons of items such as bathroom suites are representations only and may not look like the real items. Made with Made Snappy 360.

Situated in an idyllic and peaceful location on the fringes of the beautiful Lake District and enjoying tranquil countryside surroundings, this bright and spacious lodge offers a home away from home. Generously proportioned, the accommodation includes two double bedrooms, two bathrooms and an open plan living space. The surrounding outside areas include paved patio's and decking, perfect for socialising and entertaining with family and friends. Internal viewing is advised. No Chain.

Visit us at  
[www.pooletownsend.co.uk](http://www.pooletownsend.co.uk)  
[enquiries@pooletownsend.co.uk](mailto:enquiries@pooletownsend.co.uk)

We are open  
 Monday – Friday 9.00 – 5.00  
 Saturday 9.00 – 1.00

Barrow 01229 811811  
 Ulverston 01229 588111  
 Grange 015395 33316  
 Kendal 01539 734455  
 Milnthorpe 015395 62044