



**POOLE
TOWNSEND**

Stramongate, Kendal

£225,000

🛏 1 🚿 1 🚿 1



- Penthouse Apartment
- Stylishly Presented
- No Chain
- Within Walking Distance of Train Station
- Tenure: Leasehold
- Accommodation Over 2 Floors
- 1 Bedroom
- Town Centre Location
- Views Towards Kendal Castle
- Council Tax Band: B



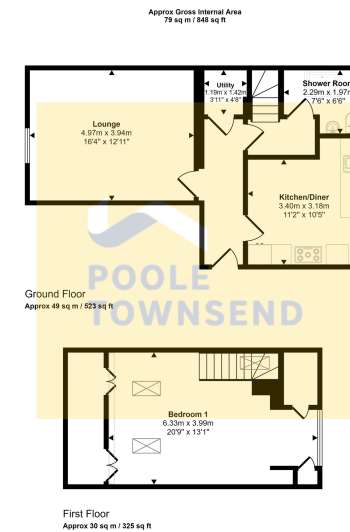

Situated in this extremely convenient location within walking distance of the train station and town centre shops is this stylishly presented penthouse apartment. Generously proportioned over two floors and enjoying views to Kendal Castle and Shap, this well appointed property features a large lounge, a modern kitchen/diner with integrated appliances, a spacious double bedroom with eaves storage and a contemporary shower room. Offered with no upper chain, this property must be viewed to be appreciated.

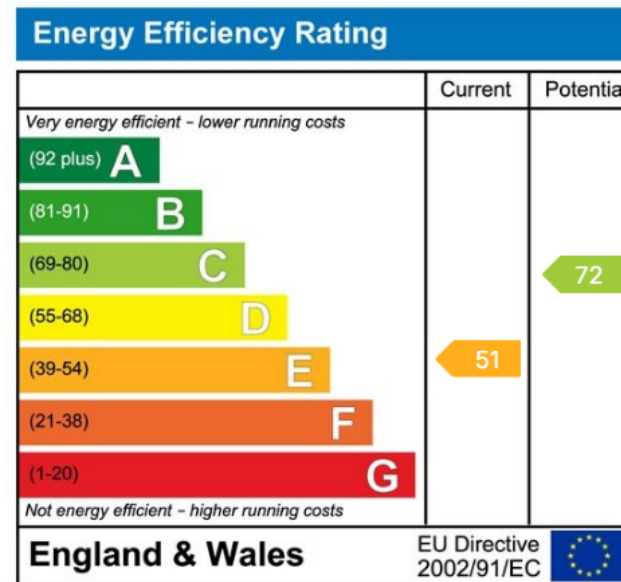

Visit us at
www.pooletownsend.co.uk
enquiries@pooletownsend.co.uk

We are open
 Monday – Friday 9.00 – 5.00
 Saturday 9.00 – 1.00

Barrow 01229 811811
 Ulverston 01229 588111
 Grange 015395 33316
 Kendal 01539 734455
 Milnthorpe 015395 62044