



**POOLE
TOWNSEND**

Stoneleigh Court, Silverdale

£289,000

3 1 1



- Spacious Three Bed Home
- Kitchen with Dining Space
- Neutral Bathroom Suite
- Large Loft Space
- Council Tax Band: C
- Lounge with Patio Doors to Garden
- Three Great Sized Bedrooms
- Ground Floor w/c
- Connected to a High Spec Waste Water Treatment System
- Tenure: Freehold



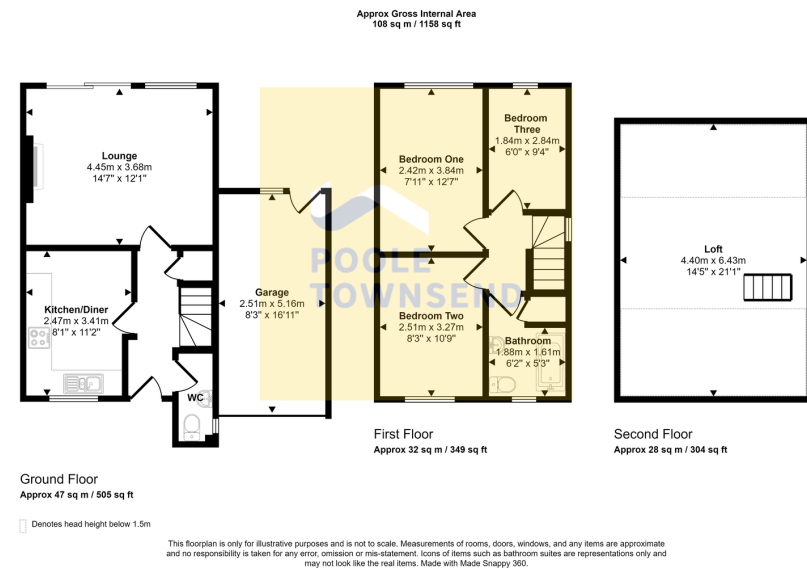

Occupying a peaceful position within the sought-after village of Silverdale, lies this superb semi-detached home. Recently decorated and ready to occupy with no upper chain, this naturally bright property features three generous size bedrooms, a modern bathroom, a kitchen/diner and a spacious lounge with French doors connecting to the enclosed lawn and patio gardens. With the added benefit of a large, fully boarded loft, a drive and attached garage, this property must be viewed to be appreciated.

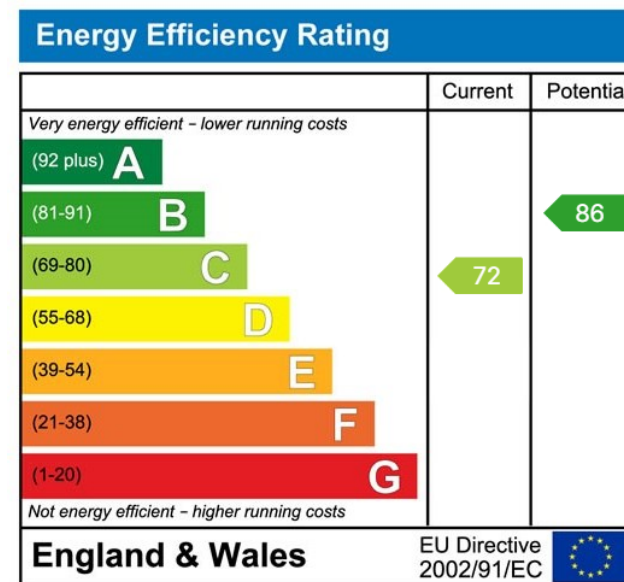

Visit us at
www.pooletownsend.co.uk
enquiries@pooletownsend.co.uk

We are open
 Monday – Friday 9.00 – 5.00
 Saturday 9.00 – 1.00

Barrow 01229 811811
 Ulverston 01229 588111
 Grange 015395 33316
 Kendal 01539 734455
 Milnthorpe 015395 62044