



**POOLE  
TOWNSEND**

# Ryleyfield Road, Milnthorpe

£125,000

🛏️ 2 🪑 1 🚗 1



- Fantastic First Floor Flat
- Two Bedrooms
- Front Garden and Enclosed Rear Patio
- Ideal Location Close to Amenities
- Council Tax Band: A
- Spacious Lounge Diner
- Neutral Bathroom Suite
- Balcony
- Local Occupancy Applies
- Tenure: Leasehold



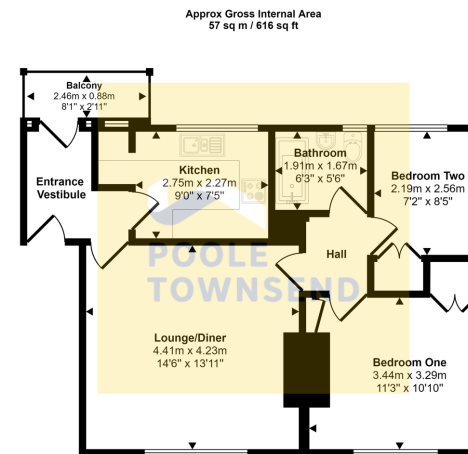

Floorplan

This floorplan is only for illustrative purposes and is not to scale. Measurements of rooms, doors, windows, and any items are approximate and no responsibility is taken for any error, omission or mis-statement. Icons of items such as bathroom suites are representations only and may not look like the real items. Made with Made Snappy 360.

Situated in a popular residential development within easy reach of Milnthorpe village amenities is this stylishly presented first floor apartment. Naturally bright and airy and finished with neutral décor and carpets, the accommodation includes a spacious lounge/diner with remote controlled electric fire, a modern fitted kitchen and bathroom and two bedrooms with built-in wardrobes. With the added benefit of a private balcony and bike store, an enclosed patio and a lawn area at the front, this property will appeal to many first time buyers looking for their first home. Local Occupancy Clause applies. No Upper Chain.

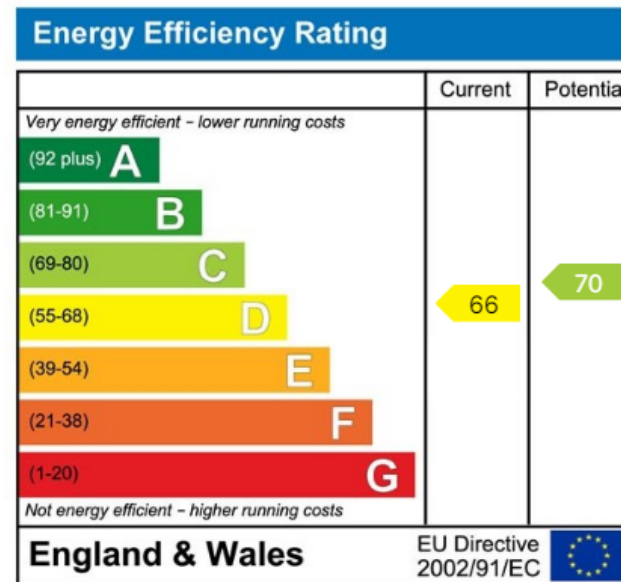

Visit us at  
[www.pooletownsend.co.uk](http://www.pooletownsend.co.uk)  
[enquiries@pooletownsend.co.uk](mailto:enquiries@pooletownsend.co.uk)

We are open  
 Monday – Friday 9.00 – 5.00  
 Saturday 9.00 – 1.00

Barrow 01229 811811  
 Ulverston 01229 588111  
 Grange 015395 33316  
 Kendal 01539 734455  
 Milnthorpe 015395 62044