



**POOLE  
TOWNSEND**

# Levens Close, Kendal, LA9 7LU

£160,000

🛏️ 2 🪑 1 🚗 1



- Ground Floor Apartment
- Spacious Accommodation
- Tastefully Decorated
- 2 Double Bedrooms
- Private Front Garden
- Drying Rights To The Back
- No Chain
- Popular Residential Area
- Council Tax Band: B
- Tenure: Leasehold



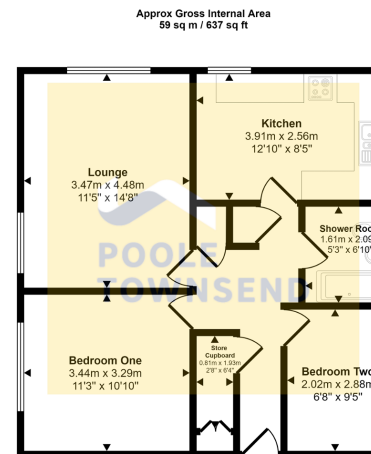

Floorplan

This floorplan is only for illustrative purposes and is not to scale. Measurements of rooms, doors, windows, and any items are approximate and no responsibility is taken for any error, omission or mis-statement. Icons of items such as bathroom suites are representations only and may not look like the real items. Made with Made Snappy 360.

Tucked away in a private residential development to the edge of the town centre is this spacious ground floor apartment. Naturally bright and tastefully decorated throughout, the property features a breakfast kitchen, a large lounge, two double bedrooms, a shower room and plenty of storage. With the added benefit of a private front garden and drying rights to the back, this property will appeal to first time buyers, couples or rental investors. No Chain.

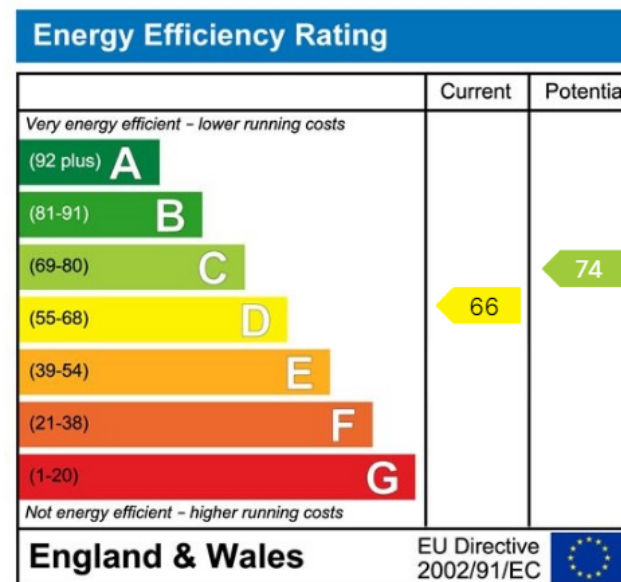

Visit us at  
[www.pooletownsend.co.uk](http://www.pooletownsend.co.uk)  
[enquiries@pooletownsend.co.uk](mailto:enquiries@pooletownsend.co.uk)

We are open  
 Monday – Friday 9.00 – 5.00  
 Saturday 9.00 – 1.00

Barrow 01229 811811  
 Ulverston 01229 588111  
 Grange 015395 33316  
 Kendal 01539 734455  
 Milnthorpe 015395 62044