



**POOLE  
TOWNSEND**



# Park Street, Kendal

£155,000

🛏 1 🚿 1 🚪 1





- Impressive First Floor Apartment
- Modern Fixtures & Fittings
- 4 Piece Bathroom Suite
- No Chain
- Council Tax Band: A
- Stylishly Decorated
- 1 Large Double Bedroom
- Outside Store
- Town Centre Close By
- Tenure: Leasehold



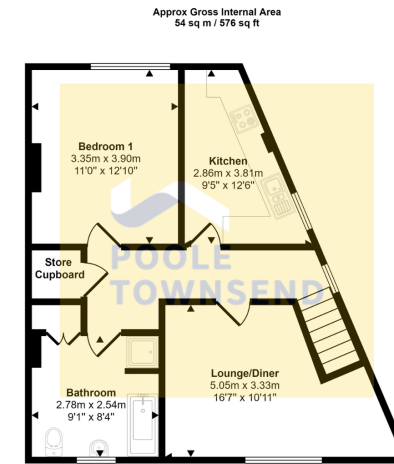

First Floor

This floorplan is only for illustrative purposes and is not to scale. Measurements of rooms, doors, windows, and any items are approximate and no responsibility is taken for any error, omission or mis-statement. Icons of items such as bathroom suites are representations only and may not look like the real items. Made with Made Snappy 360.

Surrounded by traditional stone-built properties and conveniently placed for access to the town centre and bypass, is this impressive first floor apartment. Stylishly decorated throughout with contemporary décor and modern fixtures and fittings, the accommodation includes a lounge/diner, kitchen, large double bedroom, four piece bathroom and outside store. Offered with no upper chain, viewing is highly recommended.

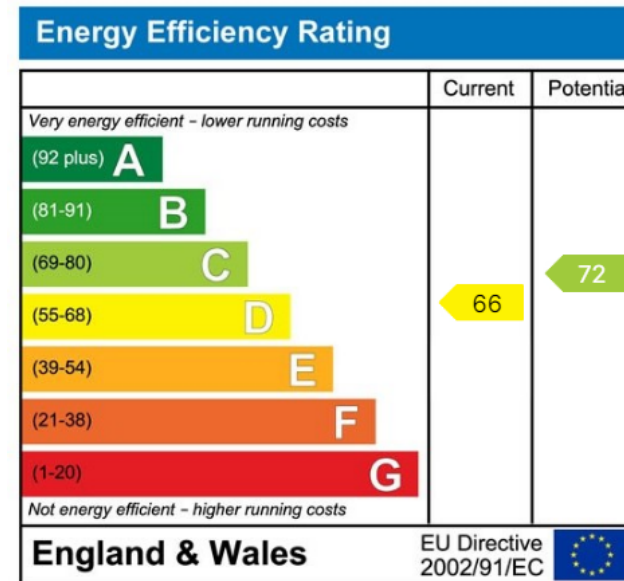

Visit us at  
[www.pooletownsend.co.uk](http://www.pooletownsend.co.uk)  
[enquiries@pooletownsend.co.uk](mailto:enquiries@pooletownsend.co.uk)

We are open  
 Monday – Friday 9.00 – 5.00  
 Saturday 9.00 – 1.00

Barrow 01229 811811  
 Ulverston 01229 588111  
 Grange 015395 33316  
 Kendal 01539 734455  
 Milnthorpe 015395 62044