



**POOLE
TOWNSEND**

Stoneleigh Court, Silverdale

£325,000

3 1 1



- Beautifully Presented Home
- Fabulous, Bright Conservatory
- Ground Floor w/c
- Fantastic Central Village Location
- Council Tax Band: C
- Neutral Breakfast Kitchen
- Three Bedrooms
- Lovely Gardens to the Front & Rear
- Connected to a High Spec Waste Water Treatment System
- Tenure: Freehold



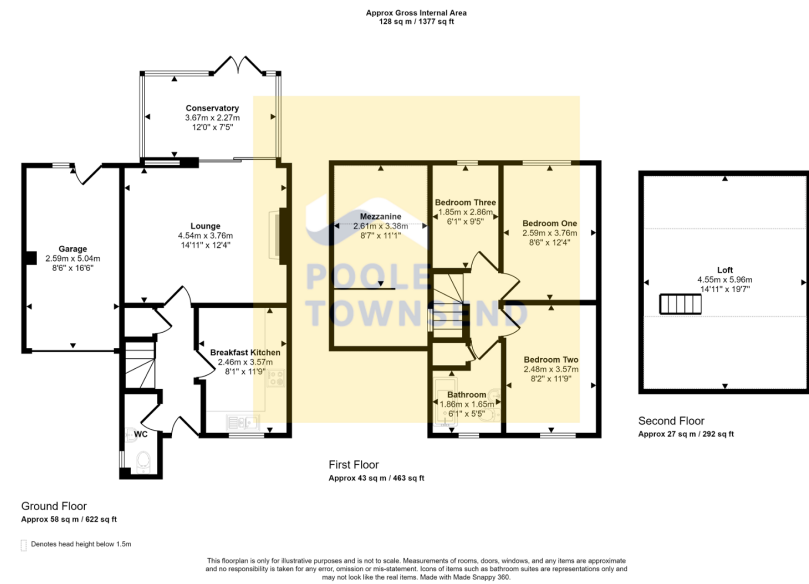

Located a stones throw from the village centre, lies this superb and perfectly proportioned home. Naturally bright and airy with storage in abundance, the property includes three good size bedrooms, two reception rooms, a kitchen, modern bathroom and additional WC. The gardens have been meticulously landscaped with areas of lawn with planted borders and a private seating area with raised beds. Complete with off road parking and an attached garage, this property must be viewed to be appreciated. No Chain.

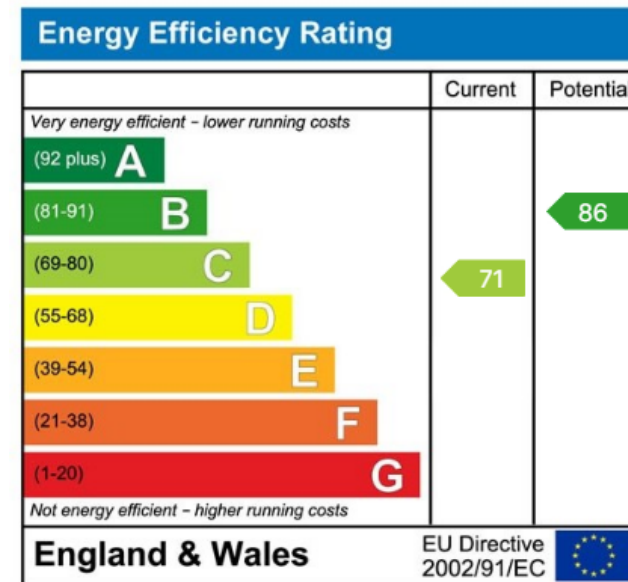

Visit us at
www.pooletownsend.co.uk
enquiries@pooletownsend.co.uk

We are open
 Monday – Friday 9.00 – 5.00
 Saturday 9.00 – 1.00

Barrow 01229 811811
 Ulverston 01229 588111
 Grange 015395 33316
 Kendal 01539 734455
 Milnthorpe 015395 62044