



**POOLE
TOWNSEND**

16 Ryleyfield Road

£215,000

3 1 1



- Beautiful, Modern Semi Detached Home
- Spacious Lounge
- Three Bedrooms
- Popular Residential Location
- Council Tax Band: B
- Stunning White Gloss Kitchen
- Useful Utility Room
- Contemporary Bathroom Suite
- Off-Road Parking
- Tenure: Freehold



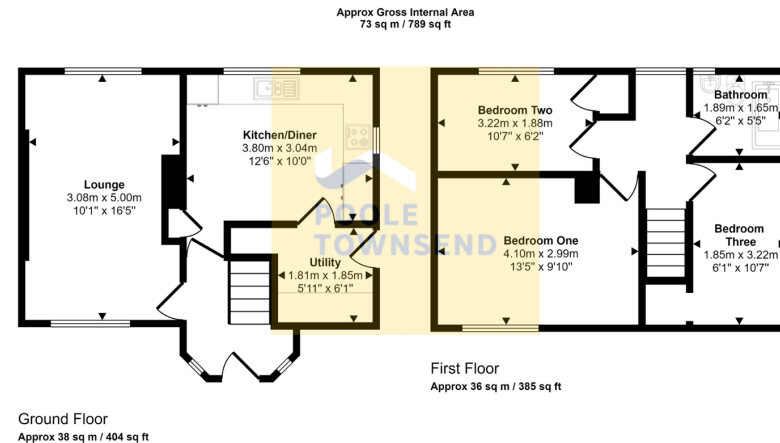

This floorplan is only for illustrative purposes and is not to scale. Measurements of rooms, doors, windows, and any items are approximate and no responsibility is taken for any error, omission or mis-statement. Icons of items such as bathroom suites are representations only and may not look like the real items. Made with Made Snappy 360.

Beautifully upgraded and modernised throughout, this three bedroom semi-detached home is in move in condition. Naturally bright and airy and finished with neutral décor and carpets, the accommodation includes a full depth lounge, kitchen/diner and utility to the ground floor and three good size bedrooms and bathroom to the first floor. Complete with off road parking for two cars and a low maintenance patio garden with planted beds, this property will appeal to many first time buyers looking for their first home. No upper chain. Local Occupancy Clause applies.

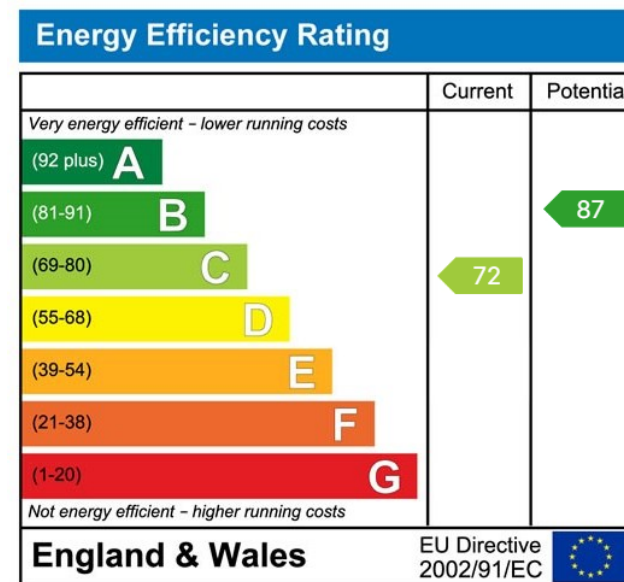

Visit us at
www.pooletownsend.co.uk
enquiries@pooletownsend.co.uk

We are open
 Monday – Friday 9.00 – 5.00
 Saturday 9.00 – 1.00

Barrow 01229 811811
 Ulverston 01229 588111
 Grange 015395 33316
 Kendal 01539 734455
 Milnthorpe 015395 62044