



**POOLE
TOWNSEND**

Silverdale Road, Arnside

£395,000

🛏️ 2 🪑 1 🚗 1



- Fabulous Detached Bungalow
- Large Bright Lounge
- Two Double Bedrooms
- Popular Village Location
- Council Tax Band: D
- Impressive Gardens
- Kitchen with Separate Utility Room
- Ample Off Road Parking & Garage
- Potential to Extend Subject to Relevant Planning
- Tenure: Freehold



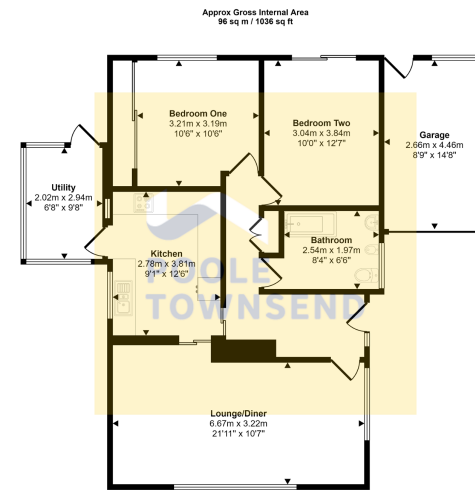

Floorplan

This floorplan is only for illustrative purposes and is not to scale. Measurements of rooms, doors, windows, and any items are approximate and no responsibility is taken for any error, omission or mis-statement. Items such as bathroom suites are representations only and may not look like the real items. Made with Made Happy 360.

Situated on a large plot to the edge of the sought-after coastal resort of Arnside is this detached true bungalow. Bright and airy throughout, the property requires modernisation and upgrading, providing buyers with a fantastic opportunity to personalise or even extend, subject to the relevant planning consents. Briefly comprising of an open plan lounge/diner, kitchen, utility, two double bedrooms and a four piece bathroom. Surrounded by large lawn and patio gardens to three sides along with ample parking and a detached single garage. No Chain.

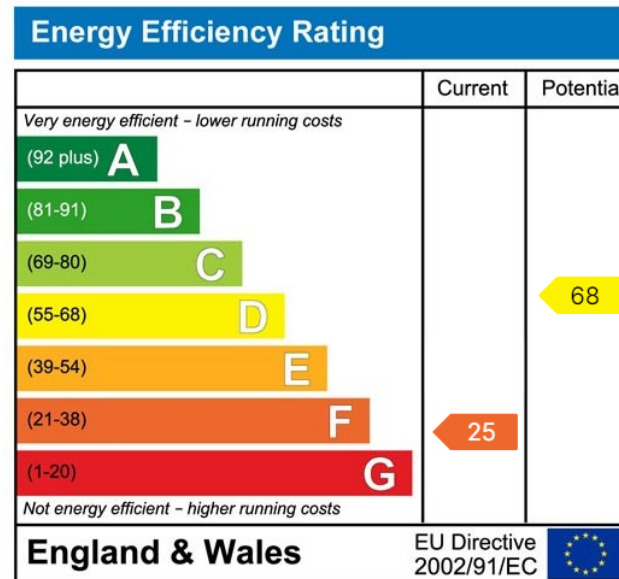

Visit us at
www.pooletownsend.co.uk
enquiries@pooletownsend.co.uk

We are open
 Monday – Friday 9.00 – 5.00
 Saturday 9.00 – 1.00

Barrow 01229 811811
 Ulverston 01229 588111
 Grange 015395 33316
 Kendal 01539 734455
 Milnthorpe 015395 62044