



**POOLE  
TOWNSEND**



## Watersedge, Sandside

Offers In Region Of £130,000

🛏 2 🚿 1 🚻 1



- Impressive Views Across the Estuary and Fells
- Kitchen with Dining Area
- Communal Gardens
- Access to Scenic Walks Nearby
- Council Tax Band: C
- Bright Open Plan Living Space
- Two Double Bedrooms
- Communal Parking Area
- Chain Free
- Tenure: Leasehold





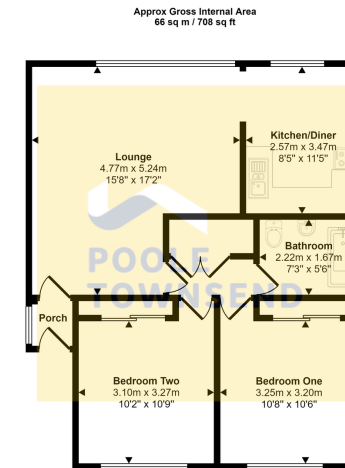

Floorplan

This floorplan is only for illustrative purposes and is not to scale. Measurements of rooms, doors, windows, and any items are approximate and no responsibility is taken for any error, omission or mis-statement. Icons of items such as bathroom suites are representations only and may not look like the real items. Made with Made Snappy 360.

Situated in a peaceful village location and enjoying stunning views across the Kent Estuary towards Whitbarrow Scar and Lakeland fells, is this delightful second floor apartment. Featuring a bright open plan living space, a kitchen, two double bedrooms with fitted wardrobes and a three piece bathroom. Outside there is parking and the shared use to the communal gardens. An ideal permanent home for couples or those seeking a holiday home close to the amenities of Milnthorpe, Storth and Arnside as well as transport links to the M6 motorway. No Chain.

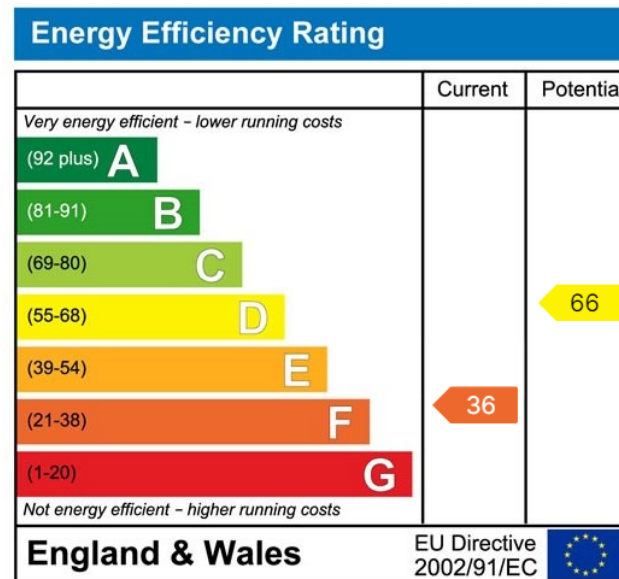

Visit us at  
[www.pooletownsend.co.uk](http://www.pooletownsend.co.uk)  
[enquiries@pooletownsend.co.uk](mailto:enquiries@pooletownsend.co.uk)

We are open  
 Monday – Friday 9.00 – 5.00  
 Saturday 9.00 – 1.00

Barrow 01229 811811  
 Ulverston 01229 588111  
 Grange 015395 33316  
 Kendal 01539 734455  
 Milnthorpe 015395 62044