



**POOLE
TOWNSEND**

Colleggate, Elleray Road, Windermere

Offers In Region Of £250,000

2 1 1



- Fantastically Proportioned Ground Floor Flat
- Open Plan Lounge Diner
- Contemporary Bathroom with Walk-In Shower
- Close to Local Amenities
- Council Tax Band: C
- Two Double Bedrooms
- Modern Kitchen
- Highly Desirable Location
- Allocated Parking
- EPC Rating: TBC



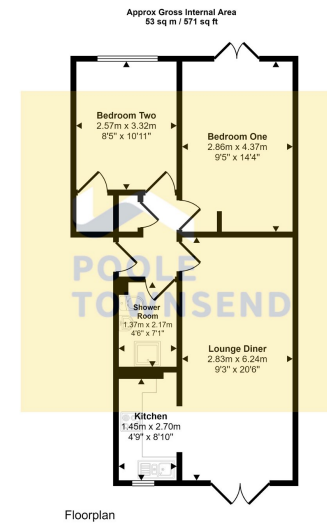

This floorplan is only for illustrative purposes and is not to scale. Measurements of rooms, doors, windows, and any items are approximate and no responsibility is taken for any error, omission or mis-statement. Icons of items such as bathroom suites are representations only and may not look like the real items. Made with Trade Snaggy 360.

Centrally located within the popular Lake District town of Windermere, is this immaculately presented ground floor apartment. Offering an open plan living room with kitchen, two double bedrooms, a modern shower room, as well as allocated parking and enclosed courtyard garden. Situated within easy reach of a wide range of boutique style shops and transport links, this property will appeal to first time buyers or those seeking a holiday home within the Lakes. A must see.

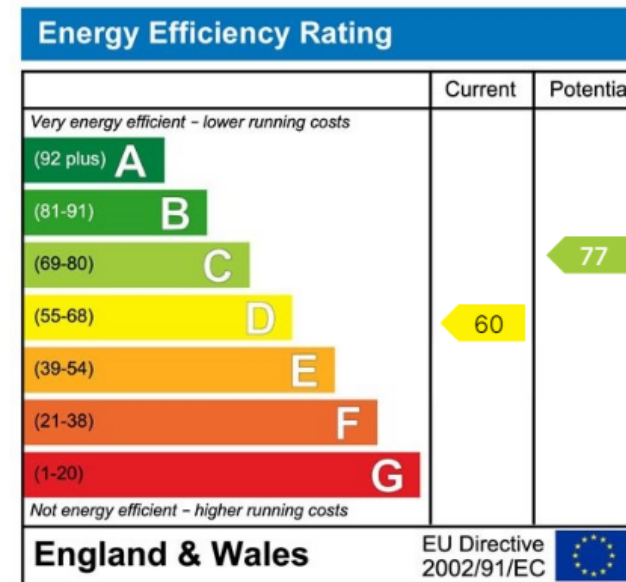

Visit us at
www.pooletownsend.co.uk
enquiries@pooletownsend.co.uk

We are open
 Monday – Friday 9.00 – 5.00
 Saturday 9.00 – 1.00

Barrow 01229 811811
 Ulverston 01229 588111
 Grange 015395 33316
 Kendal 01539 734455
 Milnthorpe 015395 62044