



Cherrywood Avenue, Surrey, TW20 0TE

£425,000 F/H



INVESTMENT BUYERS ONLY!

Currently let as a fantastic five bedroom house, we are pleased to offer what originally was a four bedroom family home and now extended on the ground floor, with two bathrooms. Currently achieving £3,000 per calendar month giving an 8.47% yield. Situated within walking distance to shops and Royal Holloway University.

Cherrywood Avenue, Englefield Green, Surrey, TW20 0TE

FLOOR PLAN

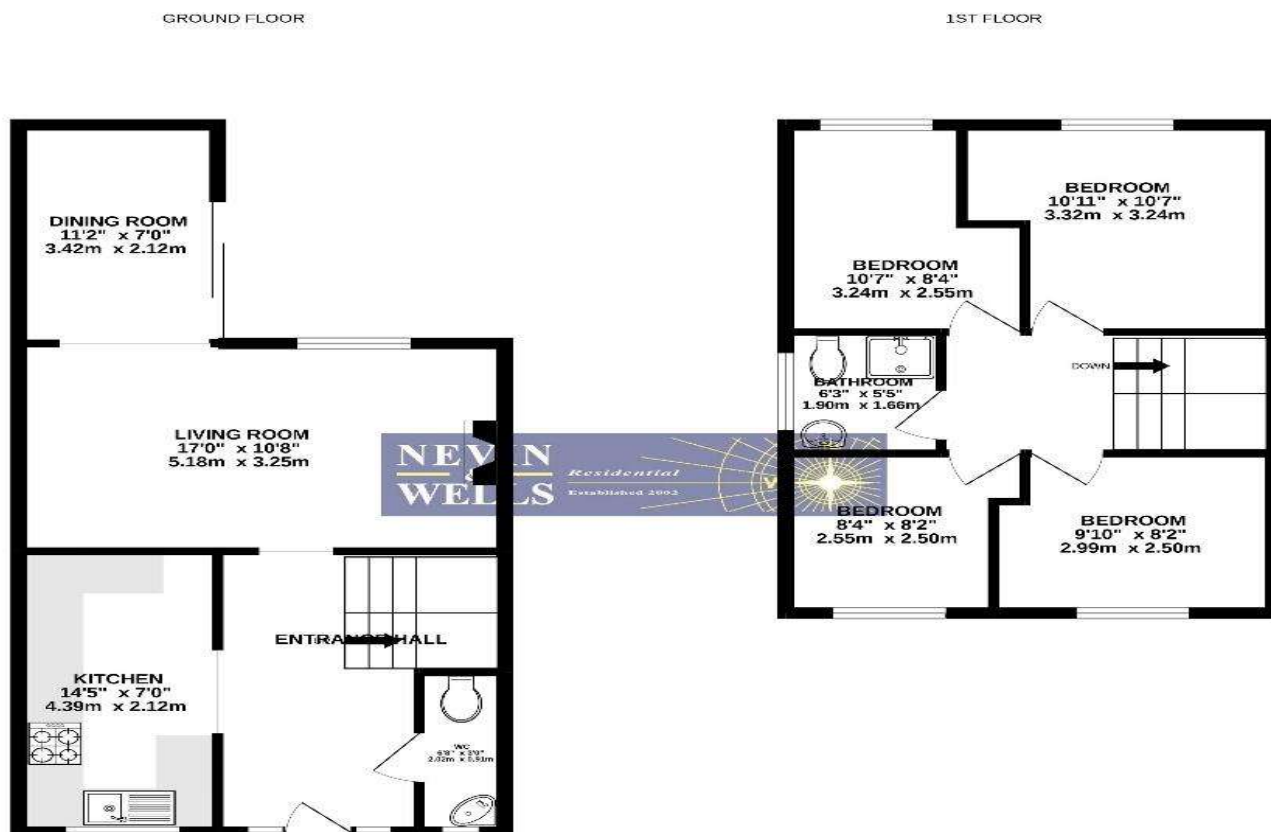

While every attempt has been made to ensure the accuracy of the floorplan contained herein, measurements of doors, windows, rooms and any other items are approximate and no responsibility is taken for any error, omission or misstatement. This plan is for illustrative purposes only and should be used as such by any prospective purchaser. The services, systems and appliances shown have not been tested and no guarantee as to their operability or efficiency can be given.

EPC

1, Cherrywood Avenue Englefield Green Surrey TW20 0TE	D
Total built area 10,000 sqm	Certificate number 0090 7000 0000 0000 0000
Property type Semi-detached house	
Total floor area 10,000 sqm	

Rules on letting this property

Properties can be rented if they have an energy rating from A to E.

If the property is rated at D or below, then a landlord must have a valid Energy Performance Certificate (EPC) for the property.

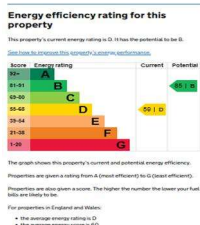

COUNCIL TAX BAND:

D - Runnymede Borough Council

VIEWINGS:

By appointment with the clients selling agents,
Nevin & Wells Residential on 01784 437 437 or
visit www.nevinandwells.co.uk



All measurements are approximate. Nevin & Wells Residential have not tested any systems or appliances.