



Vegal Crescent, Englefield Green, TW20 0PZ £350,000 F/hold



In need of renovation, a spacious two bedroom terraced home, offered for sale 'chain free'. This property benefits from large lounge with fireplace, kitchen/breakfast room, electric heating, part double glazing, parking and 60ft(18.29m) garden with feature pond. Access to village shops and recreation green is a few minutes walk. Egham Station, Runnymede National Trust and Windsor Great Park are within a mile away.

Vegal Crescent, Englefield Green, Surrey, TW20 0PZ

FLOOR PLAN

GROUND FLOOR
313 sq.ft. (29.1 sq.m.) approx.

1ST FLOOR
321 sq.ft. (29.8 sq.m.) approx.

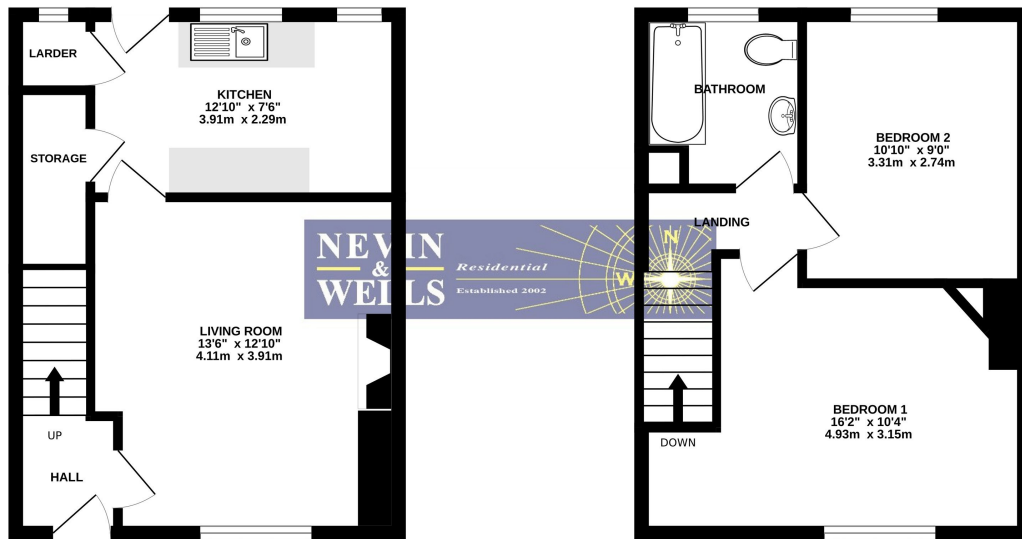

TOTAL FLOOR AREA: 634 sq.ft. (58.9 sq.m.) approx.

Whilst every attempt has been made to ensure the accuracy of the floorplan contained here, measurements of doors, windows, rooms and any other items are approximate and no responsibility is taken for any error, omission or mis-statement. This plan is for illustrative purposes only and should be used as such by any prospective purchaser. The services, systems and appliances shown have not been tested and no guarantee as to their operability or efficiency can be given.
Made with Metropix ©2024

All measurements are approximate. Nevin & Wells Residential have not tested any systems or appliances.

EPC

53 Vegal Crescent Englefield Green Surrey TW20 0PZ		Energy rating E
Valid until 12 August 2034	Certificate number 5634-7928-3400-0167-0296	

Property type	Mid terrace house
Total floor area	66 square metres

Rules on letting this property

Properties can be let if they have an energy rating from A to E.
You can read [guidance for landlords on the regulations and exemptions](#).

Energy rating and score

This property's energy rating is E. It has the potential to be B.
[See how to improve this property's energy efficiency.](#)

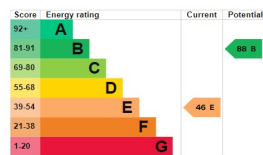

The graph shows this property's current and potential energy rating.

COUNCIL TAX BAND: D - Runnymede Borough Council

