

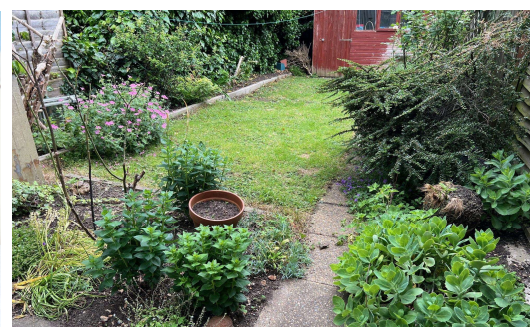

Harcourt Close, Egham, TW20 8BJ

£375,000 Freehold



In need of renovation, a three bedroom mid terrace home offered for sale 'chain free'. Benefits include large kitchen/diner, separate lounge, gas central heating, first floor bathroom, double glazing and 30ft (9.14m) rear garden. There is also potential to create a private drive to front (subject to planning). Access to local schools and shops is on your doorstep, high street shops/mainline station are a 15 minute walk away.

ZERO STAMP DUTY FOR FIRST TIME BUYERS UP TO £425,000

Harcourt Close, Egham, Surrey, TW20 8BJ

FLOOR PLAN

GROUND FLOOR
318 sq.ft. (29.5 sq.m.) approx.

1ST FLOOR
322 sq.ft. (29.9 sq.m.) approx.

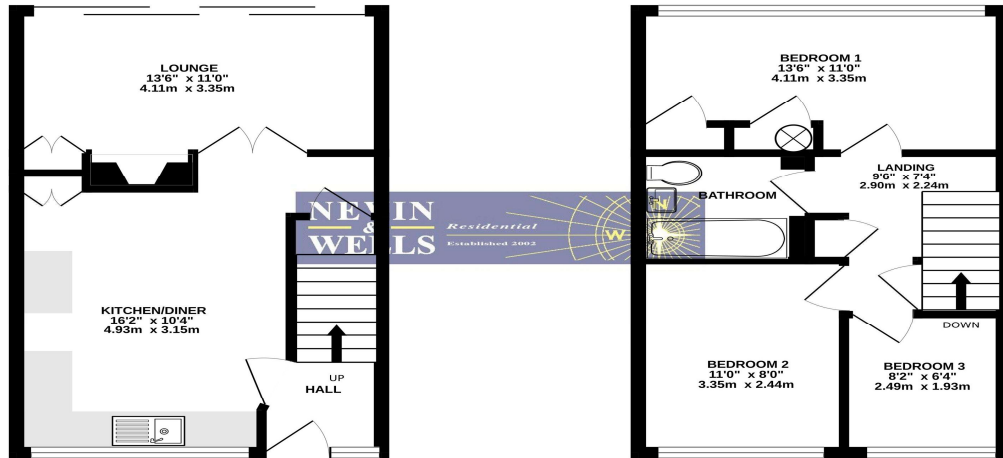

TOTAL FLOOR AREA: 640 sq.ft. (59.5 sq.m.) approx.

Whilst every attempt has been made to ensure the accuracy of the floorplan contained here, measurements of doors, windows, rooms and any other items are approximate and no responsibility is taken for any error, omission or mis-statement. This plan is for illustrative purposes only and should be used as such by any prospective purchaser. The services, systems and appliances shown have not been tested and no guarantee as to their operability or efficiency can be given.
Made with Metropix ©2024

All measurements are approximate. Nevin & Wells Residential have not tested any systems or appliances.

EPC

COUNCIL TAX BAND: D - Runnymede Borough Council



@NEVIN_AND_WELLS