



## Summers Park, Manningtree

A stylish, four-bedroom detached home with a stunning kitchen/diner, spacious living areas, and a landscaped garden. Prime location near top schools and Manningtree station, ideal for family living.

Guide price £700,000

# Cambridge Drive

## Lawford, Manningtree, CO11



- Bay-fronted
- 3 Receptions
- Easy walk to mainline railway (London in Approx. 1hr)
- Positioned on the polular Summer Park development
- Garage
- 4 Bedrooms - 2 with ensuites
- Excellent local schools and nurseries
- Sunny garden
- Utility room
- Vibrant waterside town

### The Property

Welcome to this exceptional four-bedroom, bay-fronted detached family home, nestled in the heart of the highly regarded Summers Park development. This residence is thoughtfully designed for modern family living, offering a seamless blend of comfort, style, and practicality.

Upon entering, you are welcomed into a spacious dining hall, a bright and versatile space currently styled with beautiful botanical wallpaper and herringbone wood flooring. This flexible area is perfect for formal dinners, as a second reception room, or as a stylish workspace. Off the dining hall is a convenient cloakroom/WC, ideal for guests.

To the rear of the home, the kitchen/diner forms the heart of the property. This generous space is fitted with sleek navy cabinetry, premium integrated appliances, and luxurious quartz work surfaces. A central island doubles as a breakfast bar, perfect for casual meals, while bi-fold doors open directly onto the rear garden, perfect for summer entertaining. A utility room, discreetly located off the kitchen, provides additional storage and laundry space, helping to keep the kitchen clutter-free.

On the opposite side of the ground floor, the living room offers an inviting and comfortable retreat, bathed in natural light from a bay window and thoughtfully designed with contemporary décor and elegant lighting, an ideal space to unwind with family and friends.

Upstairs, a spacious landing connects four well-proportioned double bedrooms, all beautifully presented in neutral tones with high-quality finishes. The principal suite is a true sanctuary, featuring its own dedicated dressing area and a stylish en suite shower room complete with modern tiling, a rainfall shower, and chrome fittings. The second bedroom also benefits from an en suite, offering guests or teenagers their own private space. Bedrooms three and four share a luxurious family bathroom, finished with sleek tiling, a full-size bathtub, and contemporary fixtures.

### The Outside

The property is set back from the road behind a neatly landscaped front garden, which enhances the home's kerb appeal. A block-paved driveway provides off-road parking for multiple vehicles and leads to a garage with power and lighting, ideal for secure parking, storage, or conversion to a gym or workshop.

The rear garden has been thoughtfully landscaped by the current owners, providing a private and tranquil retreat. A spacious paved patio area adjacent to the house offers the perfect spot for summer barbecues and outdoor entertaining. Beyond, a lush green lawn is bordered by mature shrubs and vibrant planting, creating a safe and serene space for children and pets to play. Raised flower beds add structure and seasonal colour, while a further patio area at the rear provides an additional seating area for enjoying the evening sun. A pedestrian door offers convenient access to the garage from the garden.





Floor Plan

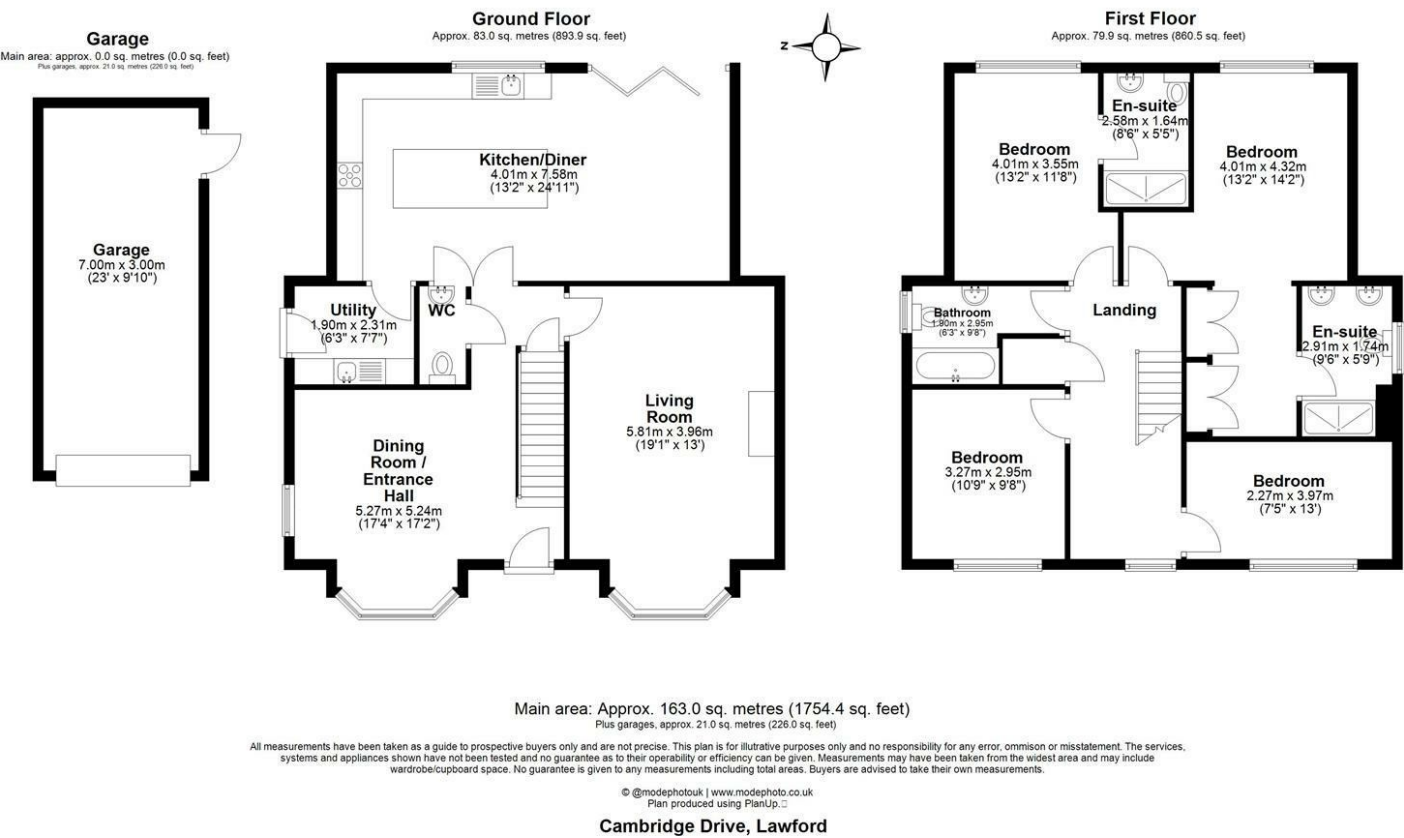

These particulars, whilst believed to be accurate are set out as a general outline only for guidance and do not constitute any part of an offer or contract. Intending purchasers should not rely on them as statements of representation of fact, but must satisfy themselves by inspection or otherwise as to their accuracy. No person in this firms employment has the authority to make or give any representation or warranty in respect of the property.

