

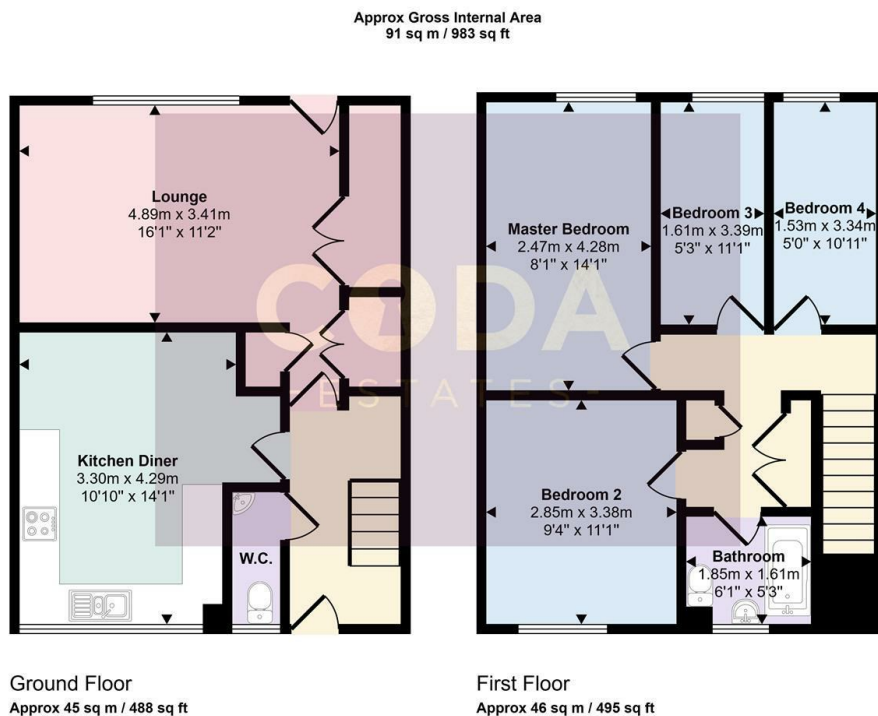

65 Etive Court, Cumbernauld, Glasgow, G67 4JA

Offers Over £140,000

- Mid Terrace
- Large kitchen and diner area
- Council Tax Band B
- 4 Bedroom property
- Gas Central Heating & Double Glazing
- EER- C
- Welcoming Entrance and Hallway
- Great internal storage



This floorplan is only for illustrative purposes and is not to scale. Measurements of rooms, doors, windows, and any items are approximate and no responsibility is taken for any error, omission or mis-statement. Icons of items such as bathroom suites are representations only and may not look like the real items. Made with Made Snappy 360.



Directions

Viewings

Viewings by arrangement only. Call 01417751050 to make an appointment.

Council Tax Band

B

EPC Rating:

C

| Energy Efficiency Rating | | |
|---|-------------------------|-----------|
| | Current | Potential |
| Very energy efficient - lower running costs | | |
| (92-plus) A | | |
| (81-91) B | | |
| (69-80) C | 74 | 80 |
| (55-68) D | | |
| (39-54) E | | |
| (21-38) F | | |
| (1-20) G | | |
| Not energy efficient - higher running costs | | |
| Scotland | EU Directive 2002/91/EC | |