

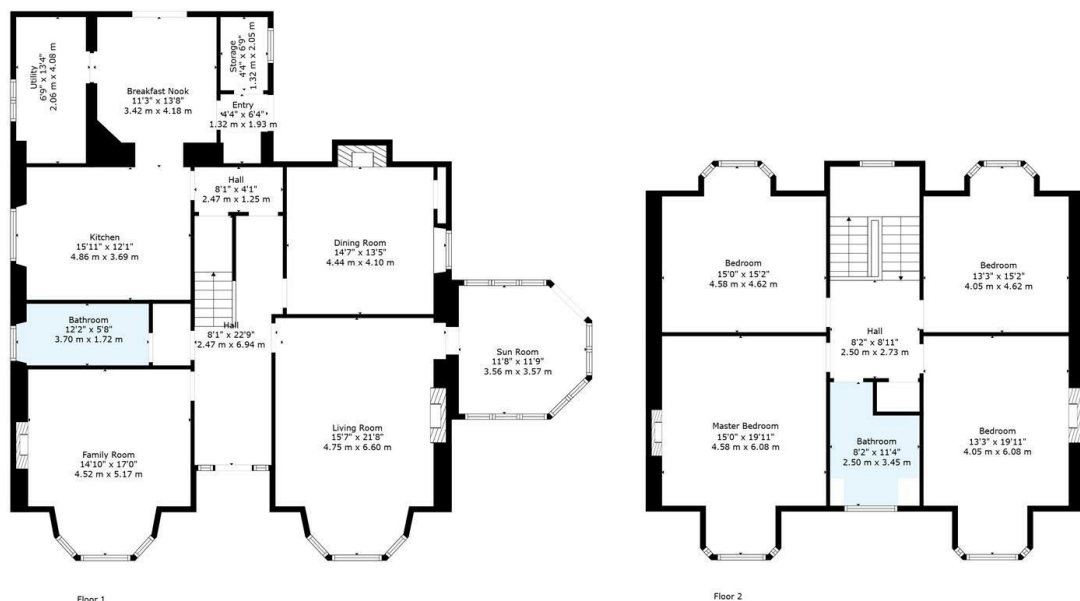

6 Beechmount Road, Lenzie, Glasgow, G66 5AD

£3,500 PCM

- Traditional stone detached
- Freshly decorated
- 2 Bathrooms
- Large levelled grounds
- Conservation area
- New modern 4 piece family bathroom suite
- Contemporary Kitchen with appliances / utility room
- Close to train station and M80
- 5 Bedrooms
- Conservatory



TOTAL: 2804 sq. ft, 261 m²
 FLOOR 1: 1686 sq. ft, 157 m², FLOOR 2: 1118 sq. ft, 104 m²
 EXCLUDED AREAS: STORAGE: 29 sq. ft, 3 m², FIREPLACE: 11 sq. ft, 1 m², LOW CEILING: 101 sq. ft, 8 m²
 Floor Plan Created By Cubicase App. Measurements Deemed Highly Reliable But Not Guaranteed.

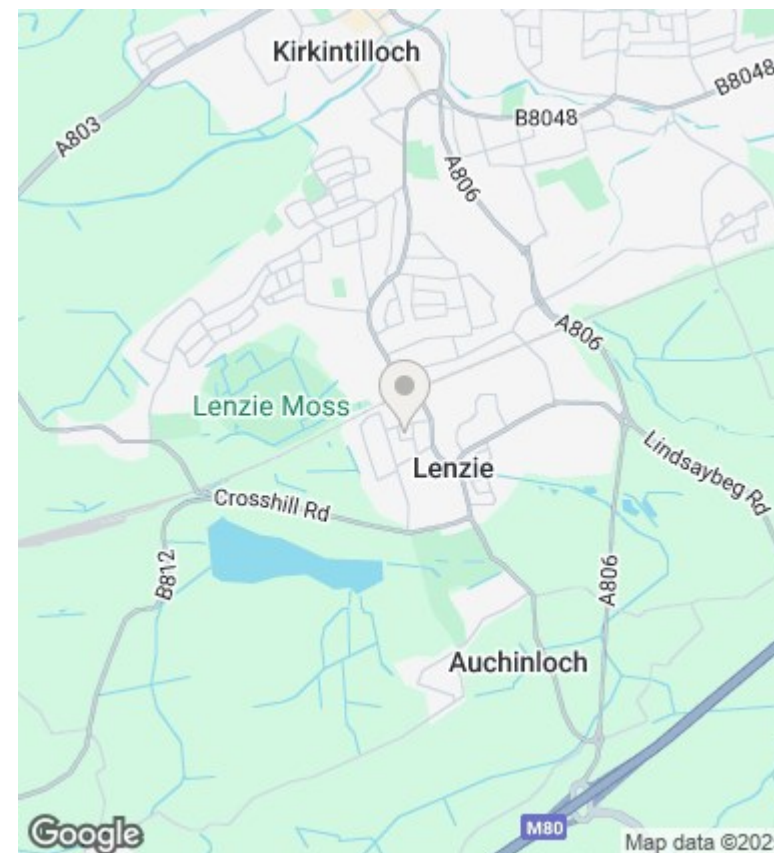

Directions

Viewings

Viewings by arrangement only. Call 01417751050 to make an appointment.

Council Tax Band

EPC Rating:

Energy Efficiency Rating		
	Current	Potential
Very energy efficient - lower running costs		
(92 plus) A		
(81-91) B		
(69-80) C		
(55-68) D		
(39-54) E		
(21-38) F		
(1-20) G		
Not energy efficient - higher running costs		
Scotland	EU Directive 2002/91/EC	